



## Manual Lodge

Distribution:

Manufacturer:

THE FLAME · Rainer Biemann  
Schalserstraße 41 · A-6200 Jenbach  
www.theflame.at · info@theflame.at

THE FLAME 04-2014

## General Information

- When setting up the Lodge, please ensure that the ground is level and stable.
- Total weight: Lodge 110 approx. 80 kg, Lodge 80 approx. 70 kg.
- Lodge is a decorative fireplace for indoor and outdoor use. Not suitable for continuous operation.
- As per installation instructions, minimum distances to flammable construction materials and objects must be maintained at all times.
- Please follow the indicated instruction guide and manual as well as the safety recommendations and warning notices!
- Please ensure that enclosed parts are installed correctly.
- National and regional regulations for the installation of this device must be observed.
- Only install the device in an area that is protected against cross ventilation.
- Simultaneous use of multiple devices is only permissible if the fuel throughput of all devices combined does not exceed 0.5 l/h (indoor use).

• Minimum room volume:



Minimum room volume m <sup>3</sup>	Air circulation* n/h	Note
163 m <sup>3</sup>	0,5	Usual air circulation rate of airtight buildings with average aeration habits of users.
81 m <sup>3</sup>	1,0	Complete air exchange inside installation room within one hour.

\*Approximate Values: • Tilted window, no shutters: Air circulation 0,3 ... 1,5  
• Half opened window: Air circulation 5 ... 10

- Your Lodge fireplace has to be examined for obvious defects before every use (burner, safety shaft).
- Appropriate aeration levels must be maintained during operation (indoor use).
- The safety shaft has to be routinely examined for burn residue and, if necessary, emptied.
- Only operate the device under supervision.

## Installation Instructions

### General Installation Instructions

- Choose an appropriate even, stable, and fireproof surface.
- Transport the Lodge carefully and wear gloves (risk of injury).
- When positioning the Lodge, ensure a minimum distance of 15 cm to flammable parts at the sides, and 200 cm to flammable parts at the top (distance from top edge of the burner).

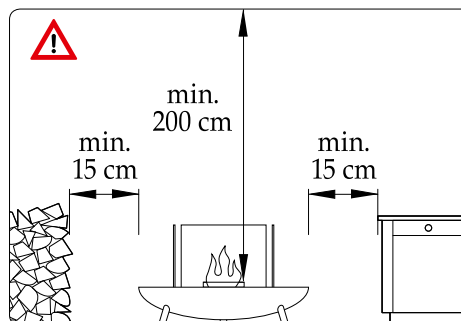

Please follow the indicated safety recommendations and warning notices!

## Installation

- ① Place the included burner inside the burn shaft.
- ② Fill the lodge with decorative stones.
- ③ Slide the glass panes into the appropriate slot.

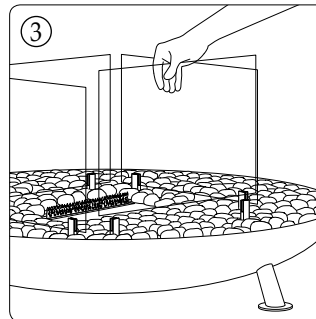
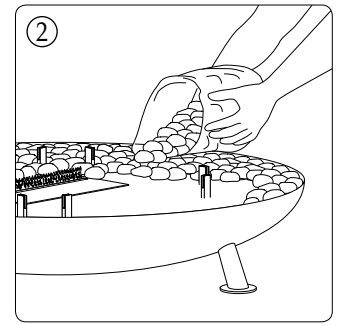
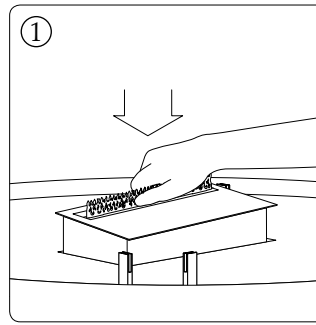

## Filling the Burner

- ④ Before using the burner for the first time, rinse it with hot water. This is done in order to clean and preheat the burner.
- ⑤ Afterwards, put the burner back into the burner shaft.
- ⑥ Taking into account the desired burn period, fill the filling container with the required amount of "Bio-Fuel - Indoor" (consumption rate is approx. 500 ml/h).
  - The maximum fill capacity of the burner is 3 liters.
  - The fuel canister has to be stored upright - only tilt it when filling the filling container.
- ⑦ Fill the burner at room temperature. Never fill the burner beyond the "MAX" marking (= maximum permissible fill level)!

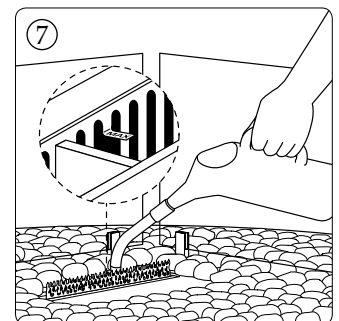
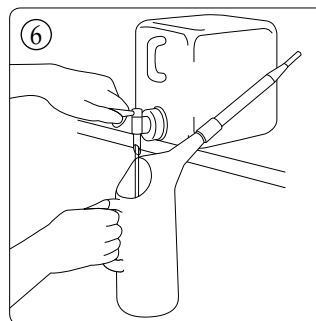
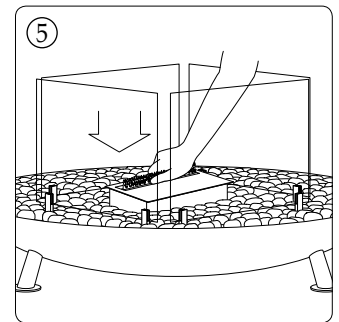
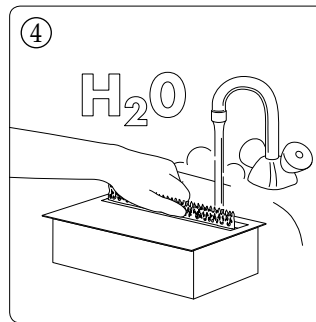

Always fill the burner only with the amount of "Bio-Fuel" required for the desired burn period (consumption rate is approx. 500 ml/h)! Please follow the indicated safety recommendations and warning notices!

- Make sure to avoid ignition sources during filling procedure (candles etc.)
- If fuel is spilled around the burner during the filling procedure, it has to be removed before igniting the burner.
- In addition, always check before each ignition whether there is any spilled fuel inside or outside the safety container. If this is the case, the spilled fuel must be removed before ignition.
- The ethanol fireplace must be examined for obvious defects before every use (burner, safety shaft).
- Always aerate the installation room.

Please follow the indicated safety recommendations and warning notices!

## Igniting the Burner

- ⑧ Dip the ignition hook into the fuel.
- ⑨ Take it out and ignite the wet hook.
- ⑩ Dip the burning hook into the fuel to ignite it. Depending on the temperature, the fire might extinguish and the hook may need to be dipped into the fuel a number of times (up to 1 minute) in order to re-ignite the fire. When lighting the burner, position yourself behind the front glass panes.

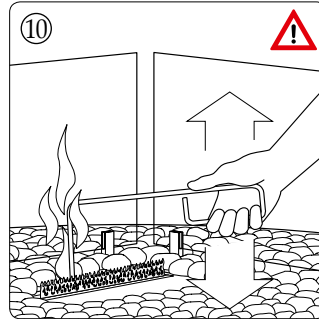
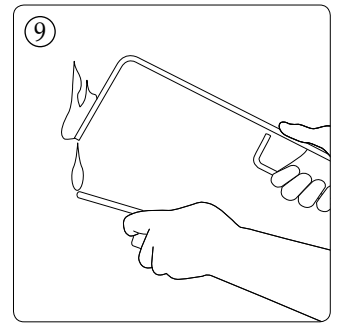
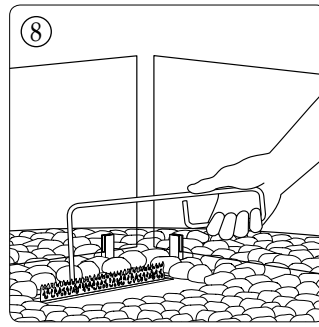

Initially, the flame will be small and have a bluish tint. After a period of approx. 10 min., the fire will reach its beautiful, calming look. If possible, always let the fire burn until the fuel is exhausted! Always ensure sufficient aeration!

## Extinguishing the Burner

- ⑪ The burner can be extinguished by closing the slide plate with the ignition hook.
  - Generally, the burner should be left burning until the fuel supply is extinguished.

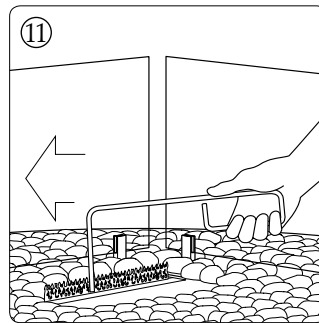

- Always let the burner cool down before touching or refilling it. 
- Please wait a minimum of 30 minutes after the flame is extinguished before refilling the burner.
- When not in use, the burner of your Lodge have to be closed with extinguishing lids.
- Never fill the burner with other flammable materials!
- Please follow the indicated safety recommendations and warning notices!

## Maintenance and Cleaning









- Occasionally, the inside of the burner should be rinsed and the outside wiped in order to remove any burn residue.
- Clean the burner after every 20 hours of operation. This is done by filling the burner with a small amount of fuel (approx. 1/8 liter) and carefully swiveling it until the residue is dissolved. Now fill the burner with hot water and discard the diluted mixture.
- The device should only be cleaned with a damp, soft cloth, without using scouring agents or aggressive cleaning products.
- The safety shaft has to be routinely examined for burn residue and, if necessary, emptied.

 Please follow the indicated safety recommendations and warning notices!

# Safety Recommendations and Warning Notices Lodge

<ul style="list-style-type: none"> <li>• This device may not be operated by children and handicapped people without supervision.</li> </ul>		<ul style="list-style-type: none"> <li>• Ignition sources absolutely must be avoided during filling procedure.</li> </ul>		<ul style="list-style-type: none"> <li>• During extended periods of operation, single-paned fire chambers present a risk of burns.</li> </ul>	
<ul style="list-style-type: none"> <li>• Keep small children away from the device.</li> </ul>		<ul style="list-style-type: none"> <li>• If during the filling process any fuel is spilled around the burner, ignition must be avoided. First, dry up and remove spilled fuel from all cracks and hollow spaces and aerate.</li> </ul>		<ul style="list-style-type: none"> <li>• Touching hot metal parts can cause burns. Be careful when handling the device while it is hot or still operating.</li> </ul>	
<ul style="list-style-type: none"> <li>• The construction of the device may not be altered.</li> </ul>		<ul style="list-style-type: none"> <li>• The device must not be filled during operation and while still warm. Please follow the instructions on the device and the burner. Temperature has to be below 24° C! Only use the filling container for filling the burner! Never use the canister for filling!</li> </ul>	  	<ul style="list-style-type: none"> <li>• Not suitable for heating or continuous operation.</li> </ul>	
<ul style="list-style-type: none"> <li>• Only spare parts that are approved by the manufacturer may be installed.</li> </ul>		<ul style="list-style-type: none"> <li>• Air grilles must not be covered or closed.</li> </ul>		<ul style="list-style-type: none"> <li>• Never cover the device or burner.</li> </ul>	
<ul style="list-style-type: none"> <li>• The instruction manual should be carefully read before operating the device.</li> </ul>		<ul style="list-style-type: none"> <li>• Never place flammable objects in or on the device or burner.</li> </ul>		<ul style="list-style-type: none"> <li>• Only operate in aerated rooms.</li> </ul>	
<ul style="list-style-type: none"> <li>• Never fill the burner with more than 3 liters of "Bio-Fuel." Only use the filling container for filling the burner! Never use the canister for filling!</li> </ul>	 			<ul style="list-style-type: none"> <li>• Extinguishing: Closing the slide plate</li> <li>• Emergency Extinguishing Procedure: Use the filling container to fill the burner with water - do not overfill!!! A fire blanket and a suitable fire extinguisher are recommended.</li> </ul>	
<ul style="list-style-type: none"> <li>• Only use recommended fuel.</li> </ul>					

# Safety Recommendations and Warning Notices Bio-Fuel

P102 Must be kept out of the reach of children.		H225 The liquid and vapors ignite easily.		<ul style="list-style-type: none"> <li>• Not suitable for consumption.</li> <li>• Only ignite and burn in the provided burner.</li> <li>• Only ignite with provided ignition hook.</li> </ul>	
P233 Keep container tightly closed.		H302 Harmful if swallowed.			
P210 Keep away from heat, sparks, open flames, and hot surfaces. Do not smoke.	 	H332 Harmful if inhaled.			
P243 Take precautions against electrostatic charge.		H412 Harmful to aquatic organisms, with long-term effects.			
					 CAS: 64-17-5 · UN 1170 Hazard Label 3



Please follow the indicated safety recommendations and warning notices!