

Operating and Assembly Instructions Electrical Endless Fire Box Top

Distribution:

Manufacturer:

THE FLAME GmbH
Schalserstraße 41 · A-6200 Jenbach
www.theflame.at · info@theflame.at

THE FLAME 05-2023

Content

Informations:	• Safety	2
	• General	2
	• Electrical connection	2
	• Operation and maintenance	2
	• Delivery package	3
Assembly instruction:	• Installation - Electrical Endless Fire Box Top manually or fully automatically	3
Operating Instruction:	• Operating - Electrical Endless Fire Box Top	5
	• Filling water tank - manually	6
	• Regulation of the flame intensity	7
Cleaning - manually:	• Cleaning - Electrical Endless Fire Box Top	8
Cleaning - fully automatically:	• Cleaning - Electrical Endless Fire Box Top	10
	• Maintenance and cleaning	13
Danger and warning symbols:		13



Please pay close attention to the notes!

Information - Safety

- Please keep these instructions in a safe place for future reference.

When using electrical equipment basic precautions should always be taken in order to avoid the risk of fire, electric shock and other injury to persons. Such precautions should include the following measures:

- If the unit is damaged, consult the dealer before installation and use.
- Do not use the unit outdoors, or in the direct vicinity of a bath or swimming pool.
- The unit must not be positioned directly below a fixed electrical socket or connection box.
- The unit is not suitable for children or persons without the assistance or supervision of a third person, in the situation in which the safe use of the unit is not possible due to a physical or mental condition or due to reduced perception.
- Children must be supervised, to ensure that they do not play with the unit.
- If the unit is covered, there is a risk of fire.
- In the event of a fault, pull out the mains plug of the unit.
- Pull out the mains plug of the unit, if the unit is not to be

used for a long period of time.

- The unit must be positioned, such that the mains plug is accessible.
- If the mains plug becomes damaged, it must be replaced by the manufacturer or by a customer service centre or a comparably qualified person, in order to exclude sources of danger.
- Under no circumstances must the unit be operated if the lamps are not functioning.
- The lamps are to be examined regularly.
- In order to avoid overheating, the unit must not be covered. This is indicated on the unit by a warning symbol. Do not lay any objects or articles of clothing on the unit and do not obstruct the circulation of air around the unit.
- Restricted life of lighting equipment, ultrasonic membranes, fans and Effect Burners - up to approx. 3,000 hours.
- Before cleaning the fire Effect Burners the mains plug should always be pulled out. We recommend regular cleaning every 100 hours or at least every two weeks at the latest (obvious contamination should be removed immediately).



Information - General

- Carefully unpack the unit and store the packaging for later use, e.g. for relocation, for returning the unit to the dealer or service return.
- The remote control and the batteries are packed separately in the carton.
- The unit is equipped with a fire effect without heating function.

- The fire effect consumes very little electrical energy (e.g. Endless Fire Box Top 130: 800 W).
- This unit is intended for installation in a border, or in an installation opening in a wall.
- The operating noise can be heard under certain circumstances, due to the fire effect. This is normal and is no reason for complaint.



Information - Electrical connection

WARNING - THIS UNIT MUST BE EARTHED.

- This unit must only be connected to an alternating current power supply (AC supply).

- The voltage stated on the unit must be the same as the actual available supply voltage.
- Read the safety instructions and operating instruction carefully before switching on the unit.



Information - Operation and maintenance

- Use only **"BIO-FLUID"** from **"THE FLAME"** or **distilled water** in this unit.
- Always make sure that the unit is standing on a level surface.
- After installation this unit must not be moved or laid on its back, without first ensuring that the water in the sump and water tank has been emptied.
- Pull out the drawer only when filling the water tank or in the event of replacing a lamp, because otherwise you may accidentally change the water level and the behavior of the fire effect function.
- We inform you that a maximum, continuous operating time (ON) of ten hours must not be exceeded. After ten hours continuous operating time the effect burner has to be switched off for at least two hours (OFF) - after

the two hours the burner can be started again for 10 hours (ON). Exceeding the max. 10 hours of continuous operation (ON) may result in damage to technical components. Please note that any liability or warranty for any damage or necessary repairs due to exceeding the operating time is null and void.

- If the unit stands unused for longer than 1 week, the water must be drained from the sump and water tank and the sump dried out.
- Every 150-200 hours the water tank, sump, the sump lid, tank lid, the air filter and the ultrasound membranes must be cleaned, in particular in regions with hard water.
- Plastic parts must only be cleaned using a suitable means and not cleaned in a dishwasher.



Please pay close attention to the notes!

Delivery package

Electrical Endless Fire Box Top	Endless Effect Burner	Delivery package
130	1 x 100 cm	Combustion chamber floor in steel black, Xenon lamps, Remote operation incl. batteries, Operating instruction
180	1 x 150 cm	
230	2 x 100 cm	
280	1 x 150 cm + 1 x 100 cm	
330	2 x 150 cm	
380	1 x 150 cm + 2 x 100 cm	
430	2 x 150 cm + 1 x 100 cm	
480	3 x 150 cm	
530	2 x 150 cm + 2 x 100 cm	

Assembly instruction

Installation - Electrical Endless Fire Box Top

- ① Before installing the Electric Endless Firebox Top please loosen the screws of the cover plates.

CAUTION:

Do not scratch the cover, as it is visible.



- ② Remove the cover plates including the operating flap.
- To prevent scratches, carefully place the sheets in a safe place.
- ③ Take the Endless Effect Burner(s) out of the case.
- We recommend 2 people for this activity.

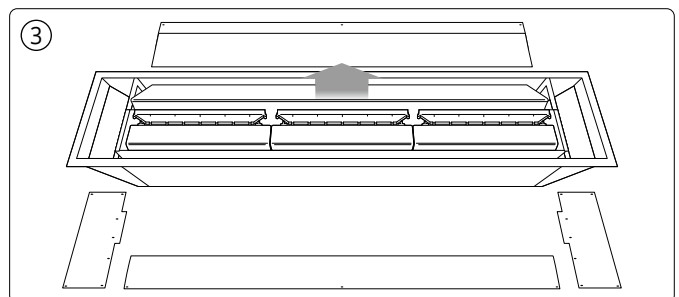
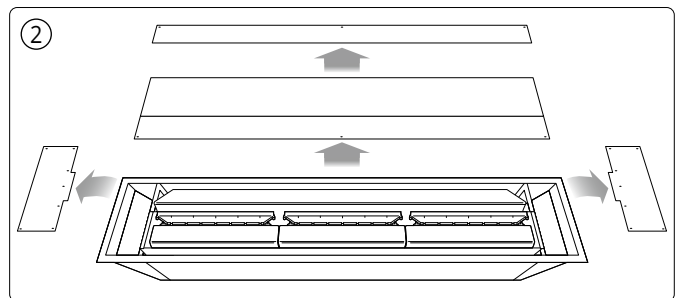
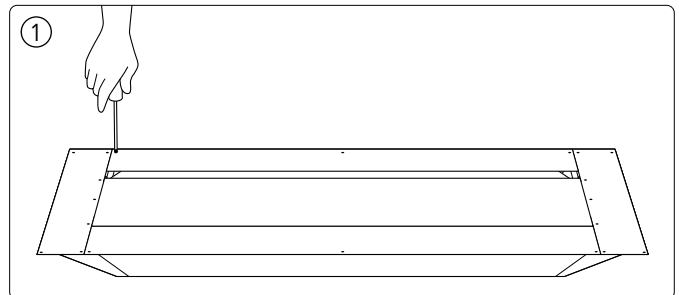

Please pay close attention to the notes!

- ④ Please install the Fire-Box Top case (housing) in your prepared gap/opening.
- Make sure there is sufficient supply air from below (flow cross-section at least 900 cm²/m of flame).
 - Make sure there is a power supply of 230 V/16 A (approx. 1 running meter flexible cable with plug).
 - From a flame length of 350 cm, an additional 230 V/16 A supply line must be prepared for the subsequent burners.

When operated with Fluidmatic and O-Box:

- Take care of the fuel supply* from the O-Box Fire-Box Top case (housing). Prepare a continuous flexible empty pipe (ø 25 mm) for the feeding of the O-Pipe (O-Pipe inner diameter 6 mm).
- * Distilled water or purified water from the O-Box

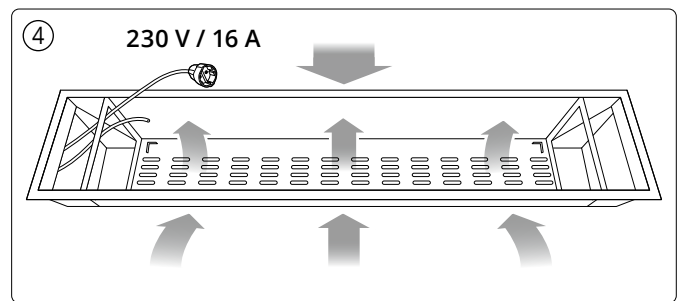

- ⑤ Air supply via grille.
- A constant supply/fresh air must be ensured below the unit. For example, via grids in the base or a base recess with opening in the base.

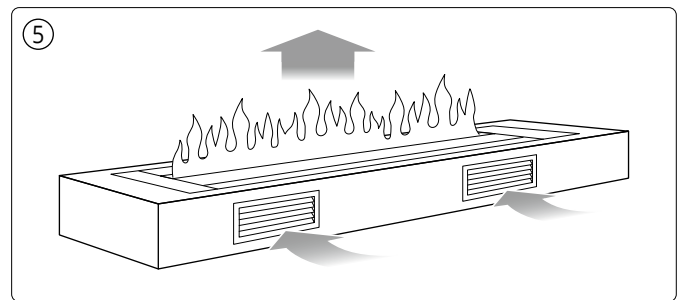

- ⑥ Air supply via openings in the base.

Ambient air

- Please note that effect fire systems are supplied with clean, purified air only. In the presence of chlorinated or salty air (e.g. pool, sea, etc.), the system must be tightly shielded from the ambient air. Fresh, clean air must be supplied mechanically from below. The fan of this external supply air must be speed controlled.

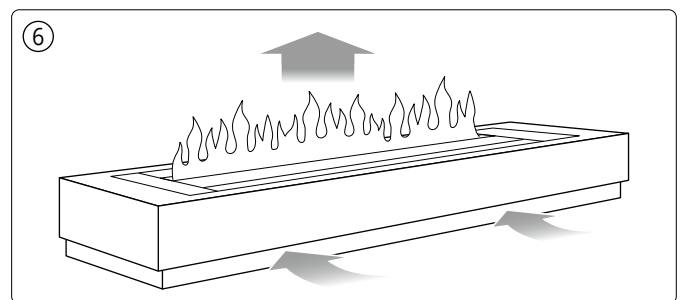

Please pay close attention to the notes!

- ⑤ Put the Endless Effect-Burner back into the Fire-Box Top housing and connect the electricity and possibly the water connection (if used with Fluidmatic and O-Box).

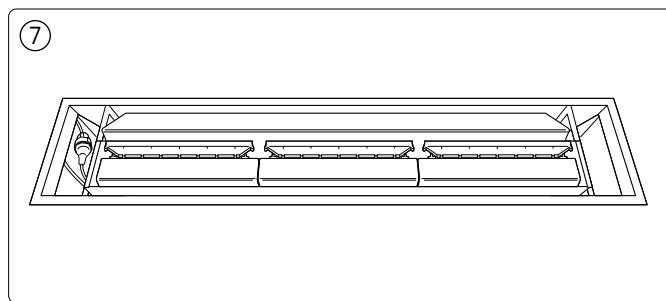

- ⑥ After the installation is complete, put the cover panels including the maintenance-trap back on the Fire-Box Top housing.

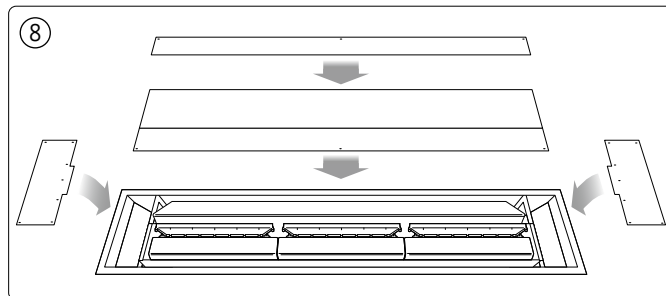

- ⑦ Fix cover panels and maintenance-trap with provided screws.

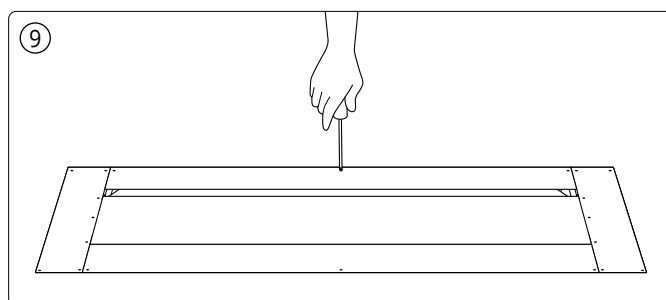

Operating Instruction

Operating - Electrical Endless Fire Box Top

- ① To open the maintenance trap, use both hands to avoid bending.

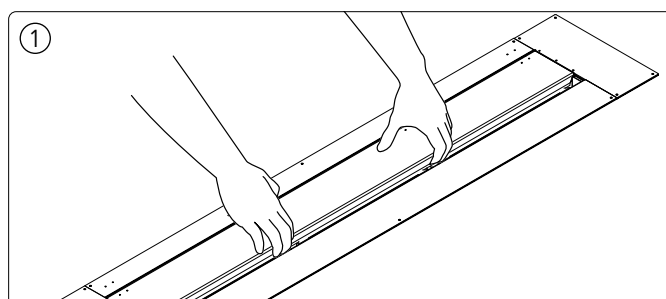

- ② Open the trap carefully upwards and avoid bending and pinching.

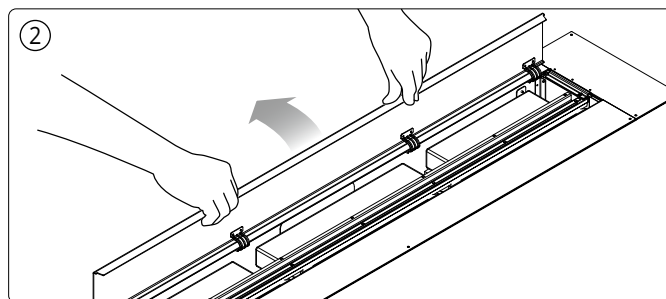

- ③ The ON/OFF switch and the control wheel for adjusting the flame intensity.

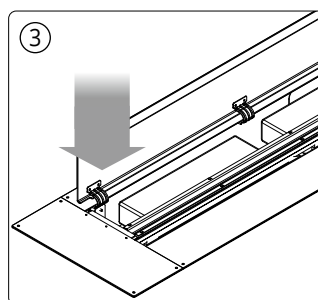

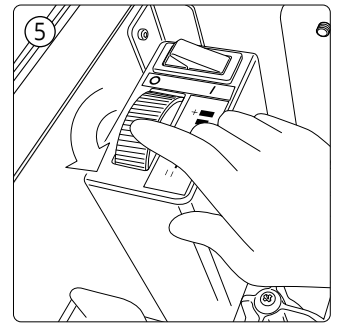
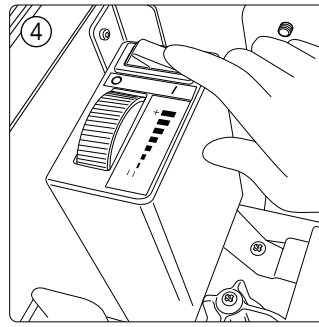

Please pay close attention to the notes!

- ④ Switch on the main switch on the Electric Endless Fire Box Top.
- ⑤ For the first commissioning, the burner should run for approx. 30 minutes on the lowest flame (turn the regulation wheel all the way down)!
 - After approx. 30 minutes, the actually desired flame intensity can be set on the control wheel (see point ⑨ and ⑩).

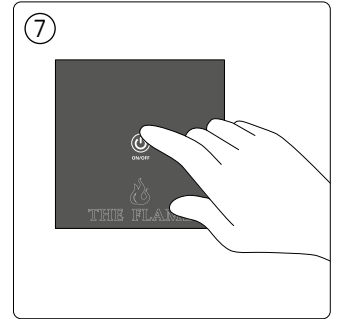
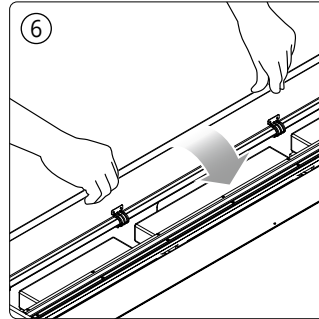

- ⑥ Close the Electric Endless Top flap.
- ⑦ Start by remote control by pressing the on/off button. This is indicated by a signal tone. As soon as the required water level is reached, the auto start of the lighting commences and after a short warmup phase of 30 seconds the fog membranes start and the flame effect begins.



For safe operation "BIO-FLUID" from "THE FLAME" and distilled water are specified as permissible substances. The use of tap water and/or other additives leads quickly to irreparable damage to the membranes and electronic components. 

Filling water tank - manually

- ① To open the maintenance trap, use both hands to avoid bending.
- ② Open the trap carefully upwards and avoid bending and pinching.
- ③ Lift the water tank up and out of the unit (for manual operation only).
- ④ Unscrew the water tank cap (counter-clockwise).

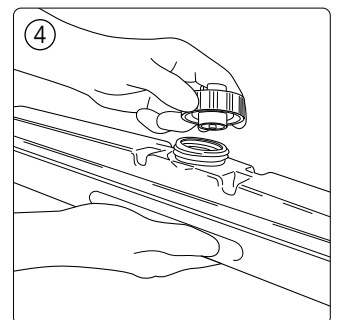
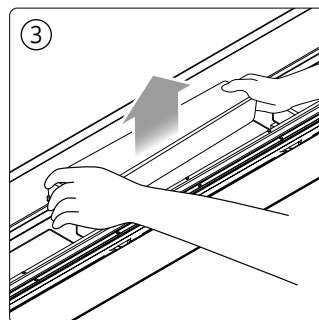
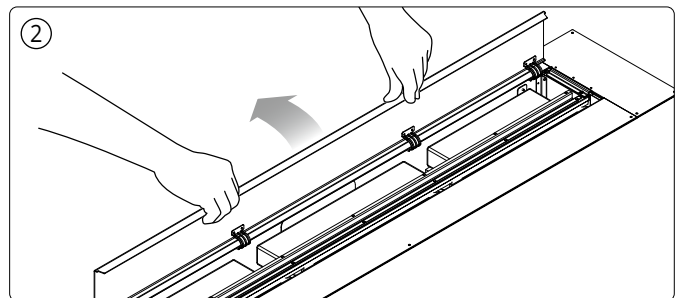
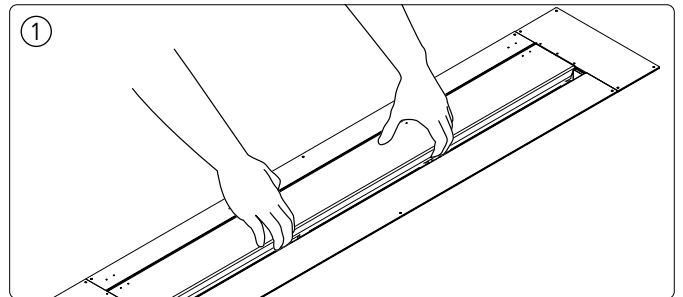

Please pay close attention to the notes!

- ⑤ Now fill the water tank with "BIO-FLUID" (Large: max. 1,9 l) or distilled water, and screw the water tank cap back on (but do not over-tighten)! Closing the tank with the screw cap must be done very carefully and with normal, light force. It should be tight, but not closed with extreme force. Capping with extreme force will damage the seal in the screw cap and lead to hairline cracks in the tank and screw cap. Hairline cracks and defective seals lead to uncontrolled leakage of water and thus to further damage.

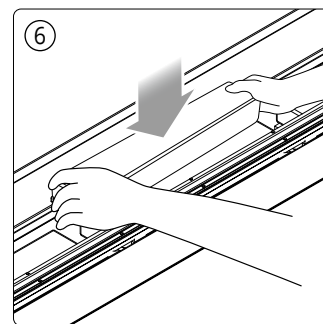
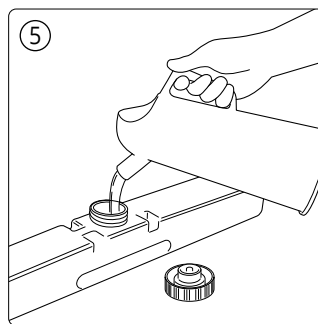

- ⑥ Reinsert the water tank. The tank cap must point downwards and the flat side of the tank point outwards.

- ⑦ Close the flap of your Electric Endless Fire Box Top. It is now ready for use again!

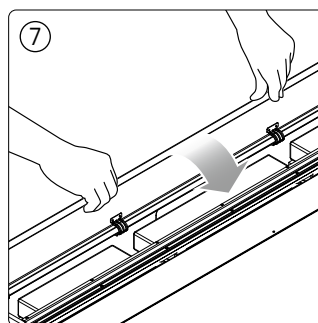

For safe operation "BIO-FLUID" from "THE FLAME" and distilled water are specified as permissible substances. The use of tap water and/or other additives leads quickly to irreparable damage to the membranes and electronic components. 

Regulation of the flame intensity

- ① To open the maintenance trap, use both hands to avoid bending.

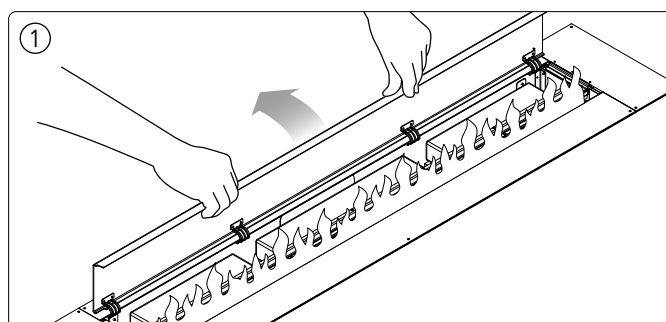

- ② Turn the regulator control upwards **+** to increase the flame intensity.

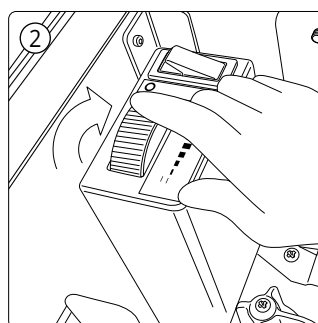

- ③ Turn the regulator control downwards **-** to reduce the flame intensity.

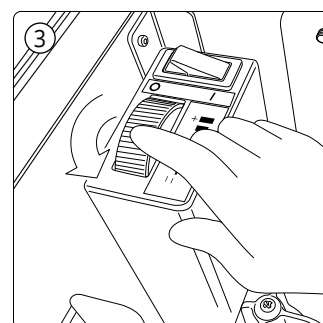

- ④ After the adjustment, please close the trap again to check the setting.

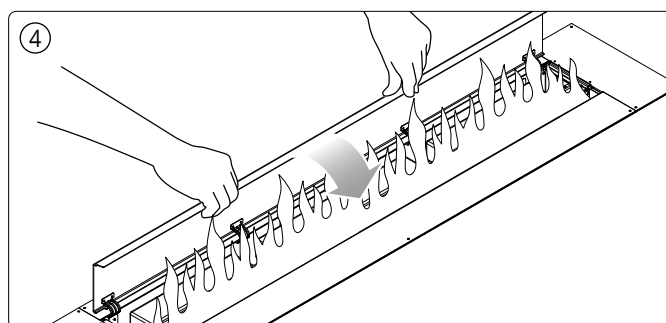

 Please pay close attention to the notes!

Cleaning - manually

Cleaning - Electrical Endless Fire Box Top

- ① To open the mainenance trap, use both hands to avoid bending.

Before cleaning the fire effect burner the mains plug must always be removed from the power socket. 

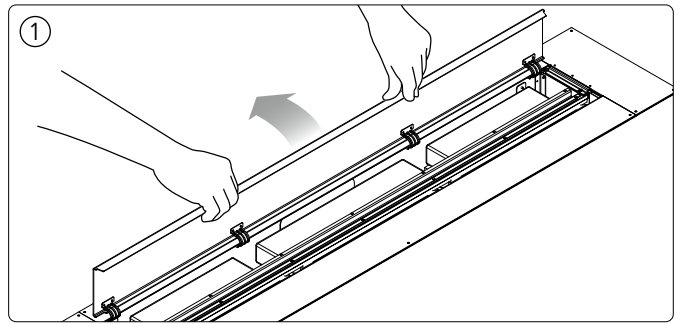

- ② Lift the water tank up and out of the unit.

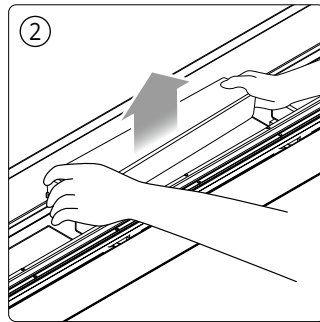

- ③ Unscrew the power and control line on the left side.

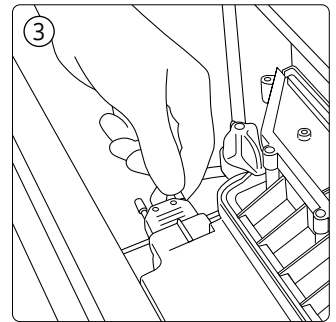

- ④ Please open the upper red lock on both sides.

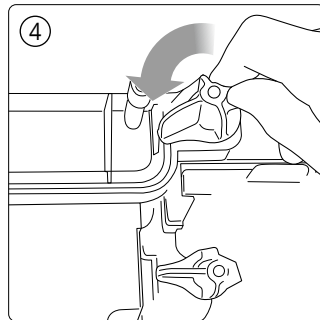

- ⑤ Now the plug-on fog-nozzle can be removed from the technical unit (sump).

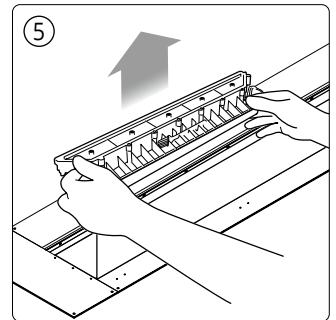

- ⑥ For cleaning please use "CLEAN" from THE FLAME a large brush and sponge.

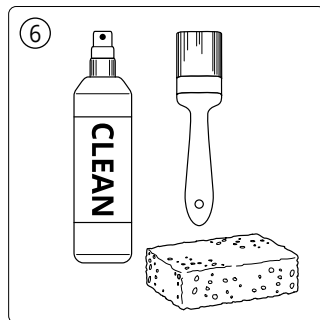

- ⑦ Vigorously spray the attachment nozzle with "CLEAN" from all sides, also inside and at the top edge.

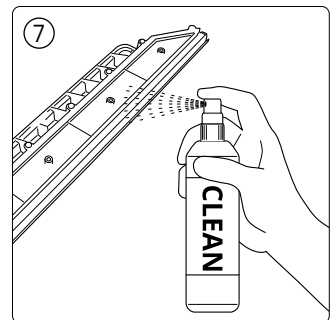

- ⑧ Cover over the the fog-nozzle with cleaning agent "CLEAN". Use a sponge or a wide brush. Clean the fog-nozzle particularly thoroughly with a sponge or a wide brush. Clean the fog-nozzle with the sponge.

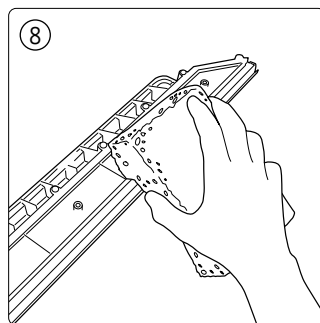

- ⑨ Rinse the fog-nozzle thoroughly with warm water and dry with a soft cloth.

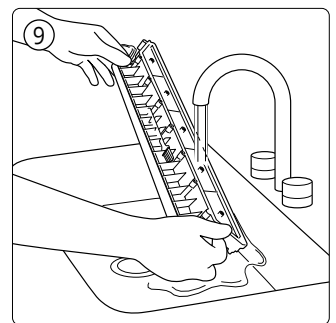

 Please pay close attention to the notes!

- ⑩ Now turn the two lower, side, red handles
- ⑪ Now the sump can be lifted up from the burner.

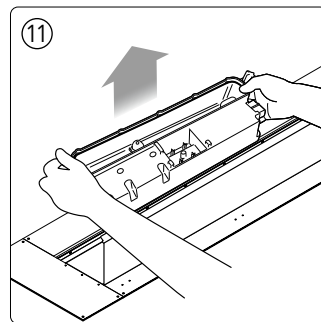
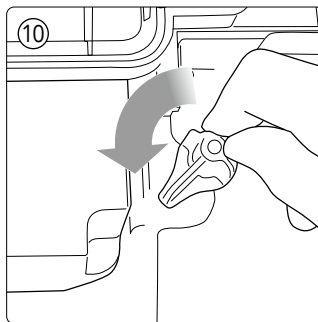

- ⑫ Drain the remaining water from the sump into a sink.
- ⑬ Spray the inside and top of the sump and the entire sump with "CLEAN". Cover over the complet Sump with the cleaning agent "CLEAN". Use a sponge or a wide brush.

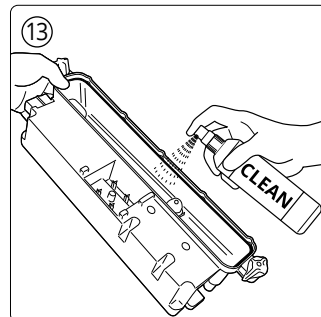
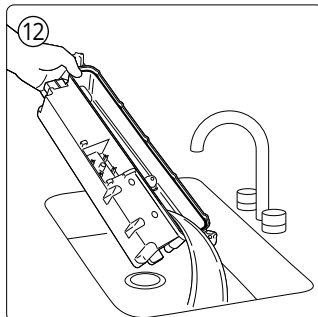

- ⑭ Clean the sump with a sponge.
- ⑮ Clean the ultrasonic membranes with the brush.

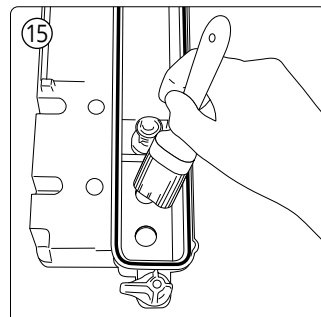
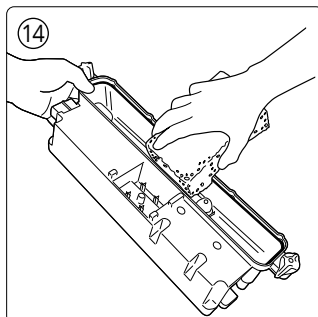

The power cable plug must not become wet! Under no circumstances must the power cable be placed in the water bath! 

- ⑯ Rinse out the sump with warm water. No atomizing and rinsing/detergent residues must remain! Dry the sump with a soft cloth.
- ⑰ Remove the fan filter, with mounting, and rinse the filter with warm water, dry and replace.

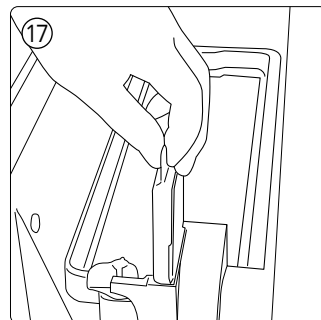
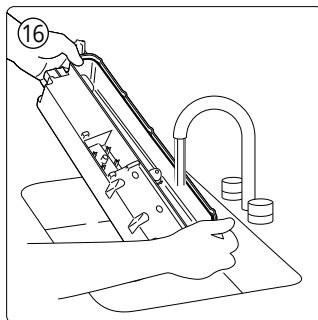

- ⑱ Replace the plug-on nozzle on the sump and secure the upper red locking device on both sides.
- ⑲ Wipe the lamps over with a damp cloth.

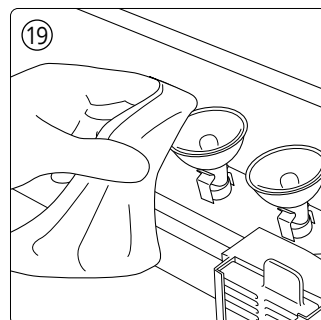
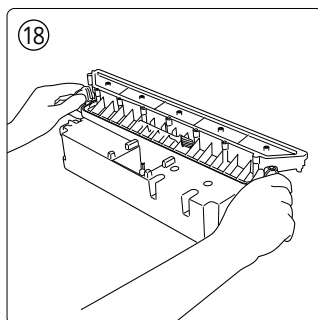

- ⑳ Replace the sump.
- ㉑ Close the lower red locking device on both sides.

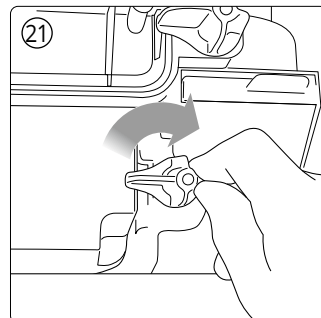
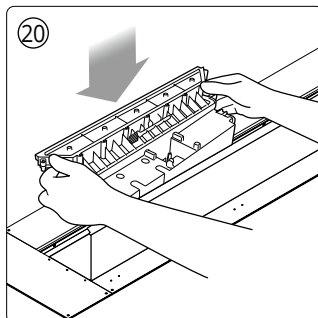

 Please pay close attention to the notes!

②② Screw the power and control line back on the left side.

②③ Replace the water tank.

- Reconnect the power supply.

②④ Close the flap of your Electric Endless Fire Box Top. It is now ready for use again!

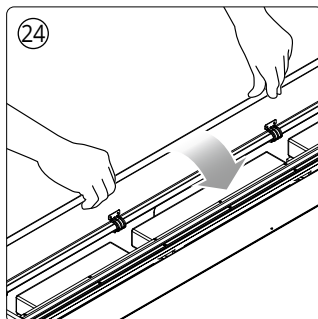
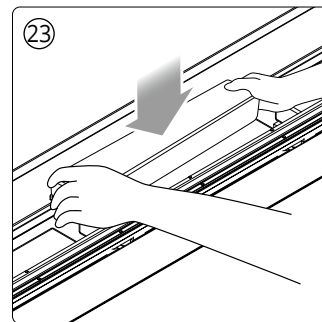
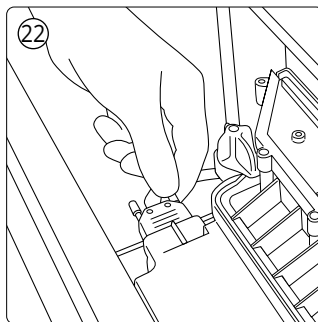

For safe operation "BIO-FLUID" from "THE FLAME" and distilled water are specified as permissible substances. The use of tap water and/or other additives leads quickly to irreparable damage to the membranes and electronic components.

Cleaning - fully automatically

Cleaning - Electrical Endless Fire Box Top

① To open the maintenance trap, use both hands to avoid bending.

Before cleaning the fire effect burner the mains plug must always be removed from the power socket.

② Lift the water tank up and out of the unit (for manual operation only). With an automatic filling system from the O-Box the water tanks can be set in or they can be stored elsewhere.

③ Unscrew the power and control line on the left side.

④ Please open the upper red lock on both sides.

⑤ Now the plug-on fog-nozzle can be removed from the technical unit (sump).

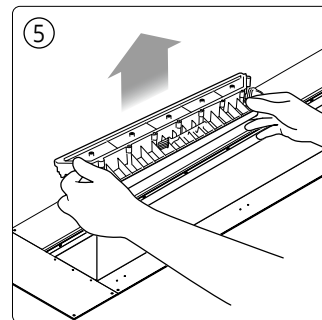
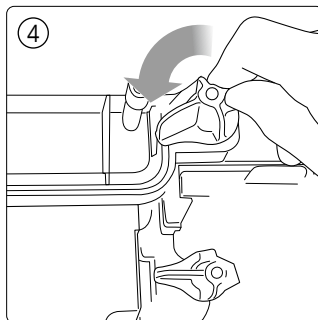
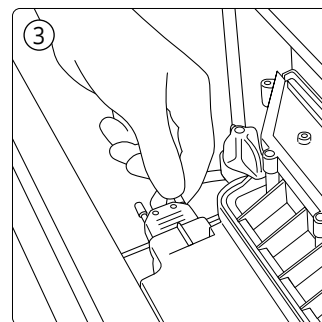
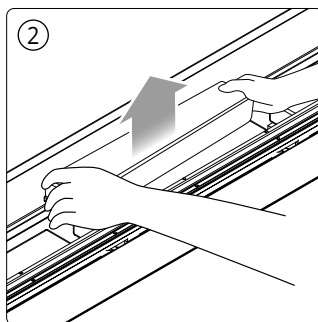
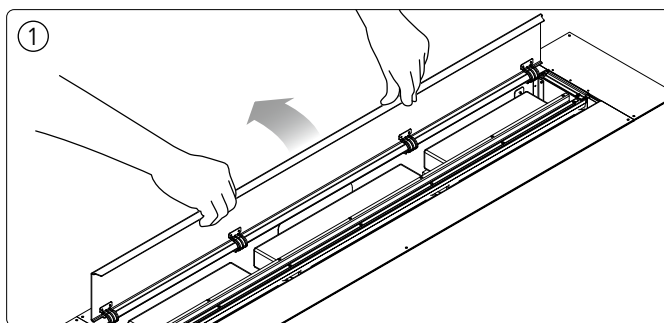

Please pay close attention to the notes!

⑥ For cleaning please use "CLEAN" from THE FLAME a large brush and sponge.

⑦ Vigorously spray the attachment nozzle with "CLEAN" from all sides, also inside and at the top edge.

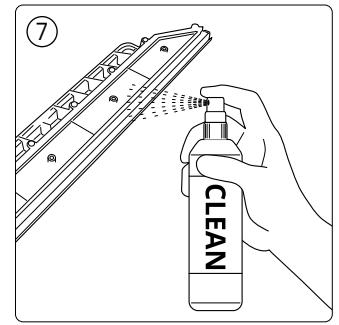
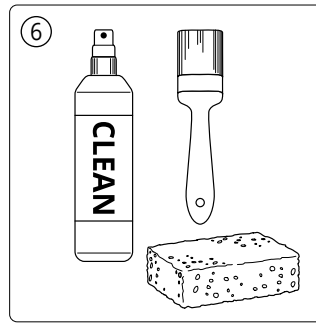

⑧ Cover over the the fog-nozzle with cleaning agent "CLEAN". Use a sponge or a wide brush. Clean the fog-nozzle particularly thoroughly with a sponge or a wide brush. Clean the fog-nozzle with the sponge.

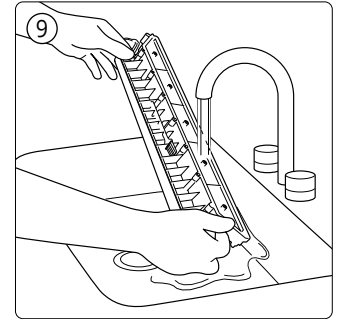
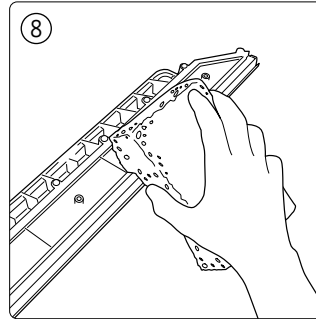

⑨ Rinse the steam nozzle thoroughly with warm water and dry with a soft cloth.

⑩ Remove the plug-on fog-nozzle from the sensor cable.

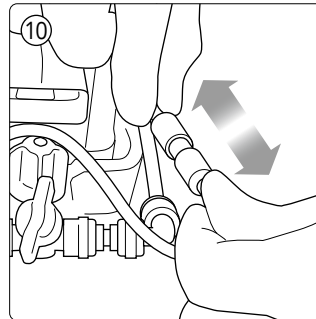

⑪ Close the valve of the piping unit inlet by turning clockwise by 90 °.

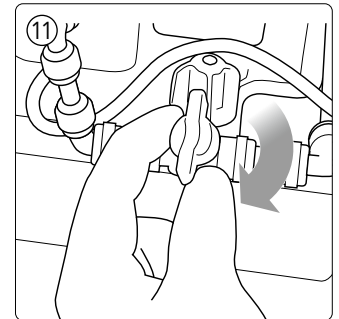

⑫ Now turn the two lower, side, red handles (left and right on the sump holder) outside around the sump.

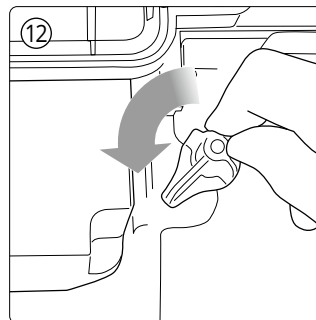

⑬ You can use the puller (optional accessory) to remove the sump from the piping unit inlet with pull the safety ring downwards and bring up the sump with the Bio-Fluid line at the same time. The piping unit inlet is now separated from the sump.

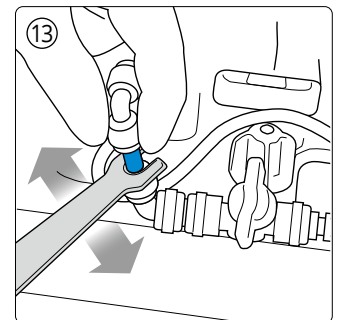

The piping unit feed can also be used without a puller from the sump connector by pressing the fuse ring e.g. press down with the fingernail, unlock and pull the sump with the Bio-Fluid line at the same time.

⑭ Now the sump can be lifted up from the burner.

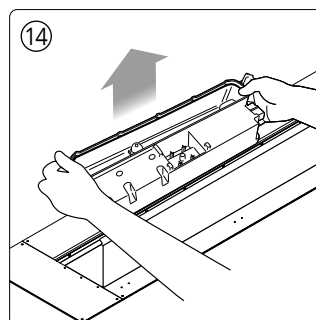

⑮ Drain the remaining water from the sump into a sink.

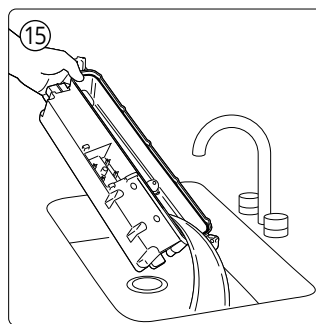

⑯ Spray the inside and top of the sump and the entire sump with "CLEAN". Cover over the complet Sump with the cleaning agent "CLEAN". Use a sponge or a wide brush.

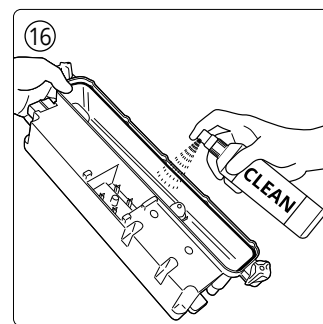

⑰ Clean the sump with a sponge.

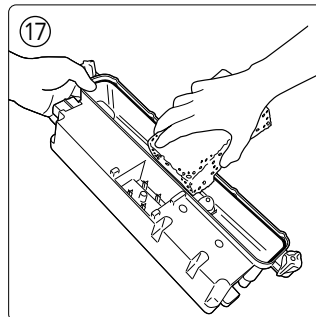

⑱ Clean the ultrasonic membranes with the brush.

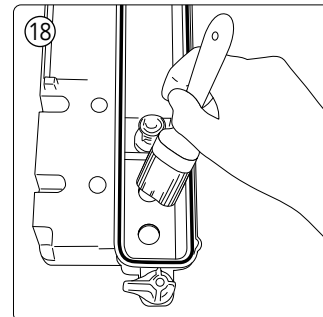

The power cable plug must not become wet! Under no circumstances must the power cable be placed in the water bath! 

⑲ Rinse out the sump with warm water. No atomizing and rinsing/detergent residues must remain! Dry the sump with a soft cloth.

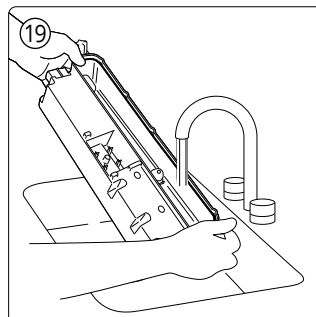

⑳ Remove the fan filter, with mounting, and rinse the filter with warm water, dry and replace.

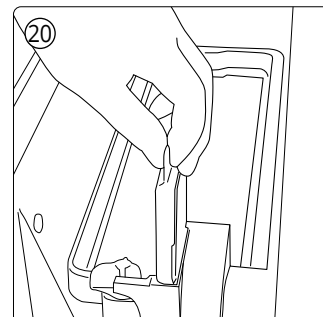

㉑ Replace the plug-on fog-nozzle on the sump and secure the upper red locking device on both sides.

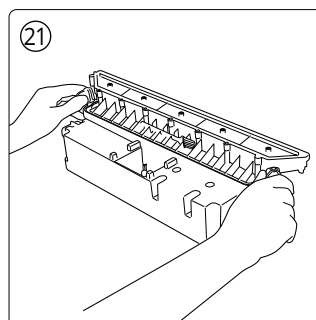

㉒ Wipe the lamps over with a damp cloth.

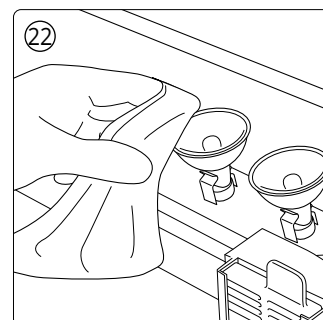

㉓ Replace the sump.

㉔ Close the lower red locking device on both sides.

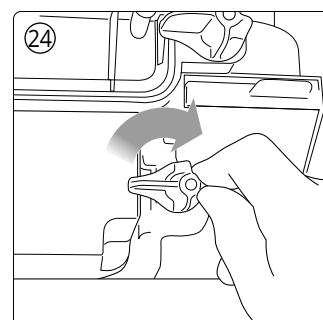
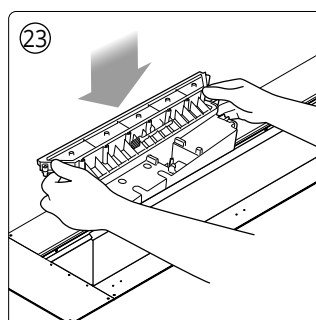

㉕ The sump can be connected with the water connection. Please pay attention that the tube is inserted up to the mark.

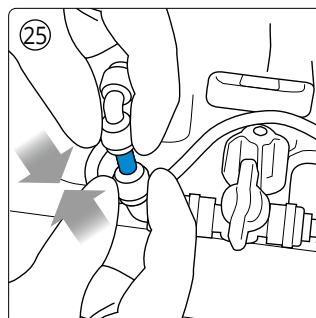

㉖ Plug the Cinch-plug again in the sensor line.

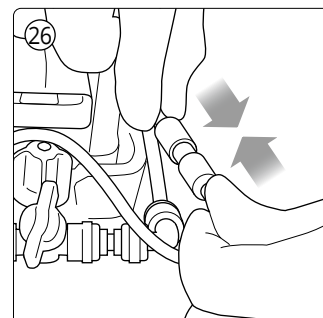

- ②7 Open the Bio-Fluid-cable valve with a turn against clock-wise for 90°.
- ②8 Plug in the plug for the control cable again. Turn the both spin sticks on the plug.

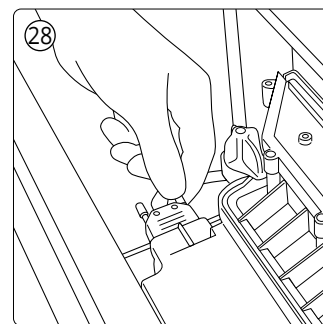
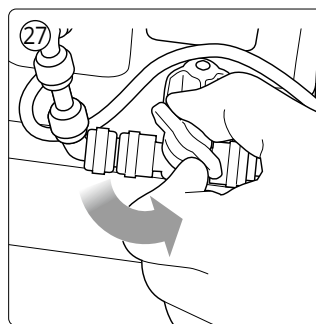

- ②9 Replace the water tank.
- Reconnect the power supply.
- ③0 Close the flap of your Electric Endless Fire Box Top. It is now ready for use again!

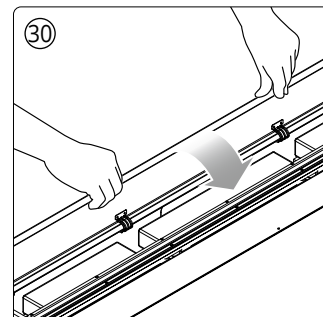
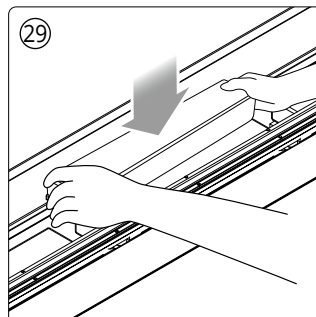

Maintenance and cleaning

Before cleaning the fire effect burner the mains plug must always be removed from the power socket. We recommend regular cleaning every 100 hours of operation or after 2 weeks at the latest (clearly, contamination/soiling should always be removed immediately). For general cleaning, always use a soft, clean dust cloth. On no account should abrasives be used. Please use "CLEAN" from THE FLAME for cleaning the sump with irrigator jets. When cleaning off collected dust deposits and fluff, occasionally a vacuum cleaner with a soft brush attachment can be used to clean the outlet grill for the fan. The sump and tank are to be emptied and cleaned when the unit has not been used for more than 10 days. Please refer to the attached Operating Instruction for the Effect Burner.

Danger and Warning Symbols

- This unit must not be used by children or by disabled persons unattended.



- Spare parts fitted to the unit must be those approved by the manufacturer.

- Do not place flammable objects in or on the unit



- The construction of the unit must not be modified.



- Before using the unit, carefully read through the operating instructions.



- Never cover the unit.

