

# Endless effect burner

Continuous, individual, ENDLESS EFFECT FIRE - even around corners. ENDLESS EFFECT FIRE can be realized in any length (at least 100 cm).

# Endless effect burner

Models Endless  
effect burner

Endless effect burner 50



Endless effect burner 100



Endless effect burner 150

# Endless effect burner

## Dimensions Endless effect burner

**Endless effect burner 50**

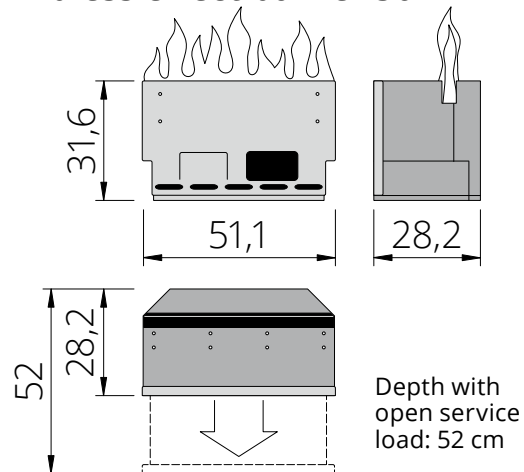

**Endless effect burner 100**

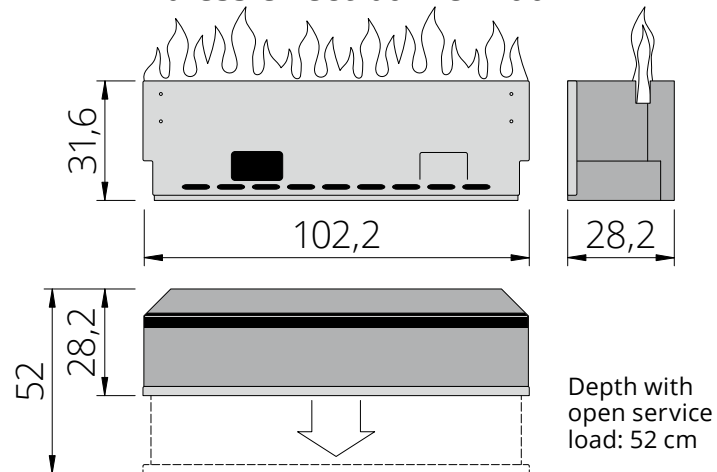

**Endless effect burner 150**

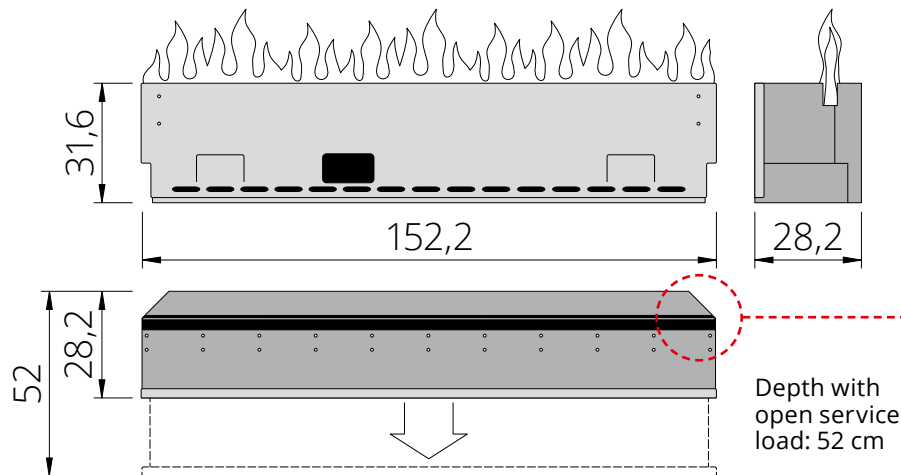

Due to its construction, each burner is suitable for installation around corner, as polygon or round.

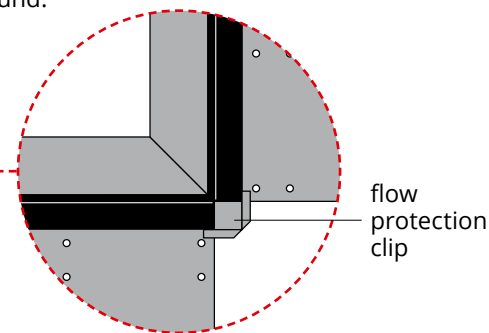

# Endless effect burner

## Components for Endless effect burner



**sump incl. ultrasonic membrane and fluidmatic**  
P.No. SUMPFLUID

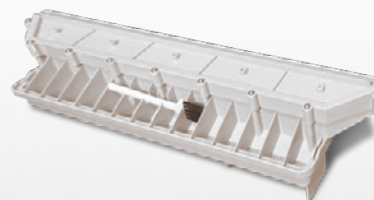

**irrigator jets (sump)**  
P. Nr.: XLDL



**sump holder incl. fan**  
P.No. XLSV



**light strip incl. wiring harness**  
P.No. XLLL



**water tank Medium**  
P.No. XMWD)  
**water tank Large**  
P.No. XLWD)  
**for manual operation**



**12 V transformer**  
P.No. TF-S



**halogen spotlights**  
P.No. HSEB



**piping unit inlet**  
P.No. OPIPEVZE

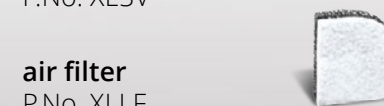

**air filter**  
P.No. XLLF

### Optional:

**connection control cable**  
P.No. OKEBK



**cable for Bio-Fluid**  
P.No. OKFWSI



**TOUCH remote control**  
P.No. BSS



**puller**  
P.No. O-KD-GSF



**screws**

# Endless effect burner

## Components for Endless effect burner

- 1 housing with fire slot
- 2 service load
- 3 control panel
- 4 handles for opening
- 5 ventilation slots
- 6 light strip incl. cable harness
- 7 sump holder incl. fan
- 8 air filter
- 9 halogen spots
- 10 technical unit (sump incl. ultrasonic membrane)
- 11 plug-on nozzle (sump)
- 12 water tank for the manual filling
- 13 piping unit inlet
- 14 plug connection of the sensor cable
- 15 plug in of the control cable





# Endless effect burner

Preparing the Endless effect burner for installation in a THE FLAME Endless Fire Box or similar.



**1** Open the service load at the intended position handles. Pay attention for a firm stand! Tipping!



**2** Remove the tanks for the manual filling.

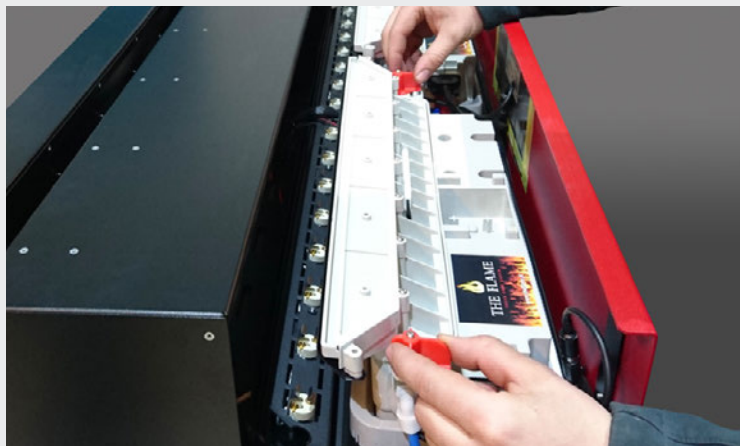

**3** Now turn the two upper, side, red handles (left and right on the plug-on nozzle) to the outside in order to be able to remove the plug-on nozzle.



**4** Now the plug-on nozzle can be removed from the technical unit (sump)

# Endless effect burner

Preparing the Endless effect burner for installation in a THE FLAME Endless Fire Box or similar.



**5** All plug connections must be removed from the sump. Open the two screwdrivers on the plug by turning clockwise.



**6** Remove the plug from the control cable.

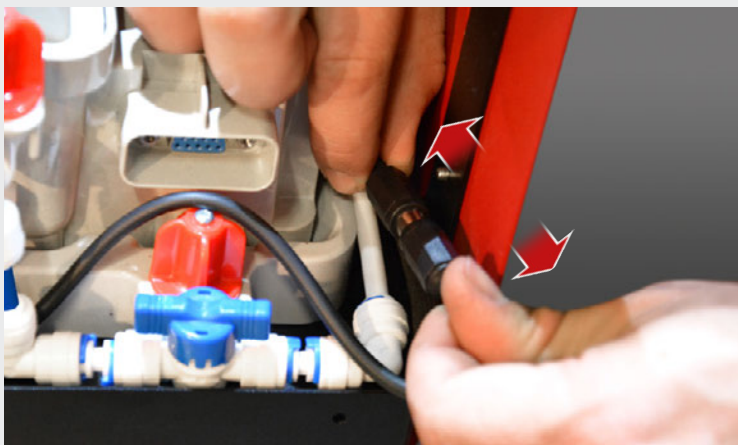

**7** Remove the plug-on nozzle from the sensor cable.

# Endless effect burner

Preparing the Endless effect burner for installation in a THE FLAME Endless Fire Box or similar.

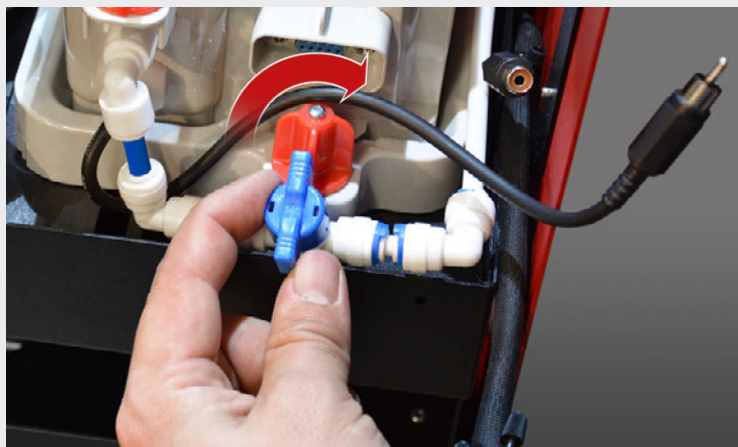

**8** Close the valve of the piping unit inlet by turning clockwise by 90 °.



**9** Now turn the two lower, side, red handles (left and right on the sump holder) outside around the sump.

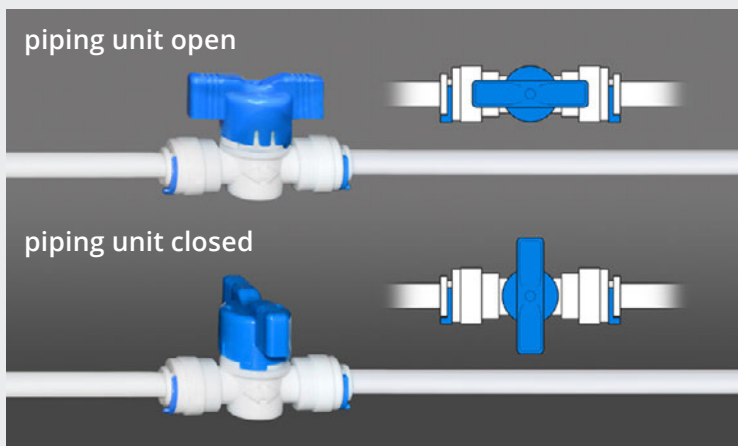

**10** Valve on the piping unit inlet open (top) and closed (bottom).

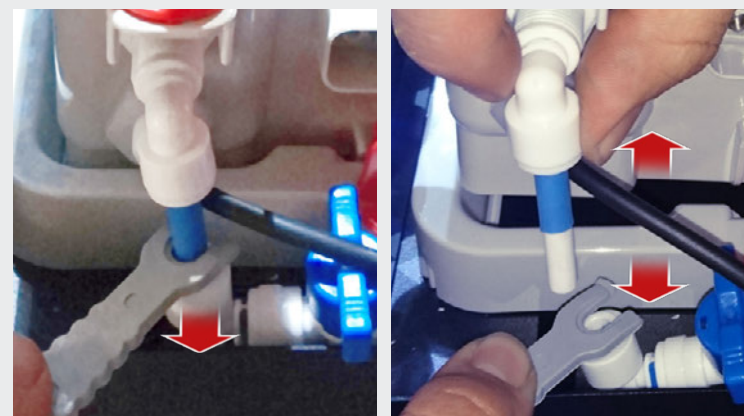

**11** You can use the puller (optional accessory) to remove the sump from the piping unit inlet with pull the safety ring downwards and bring up the sump with the Bio-Fluid line at the same time.



# Endless effect burner

Preparing the Endless effect burner for installation in a THE FLAME Endless Fire Box or similar.



**12** The piping unit inlet is now separated from the sump.

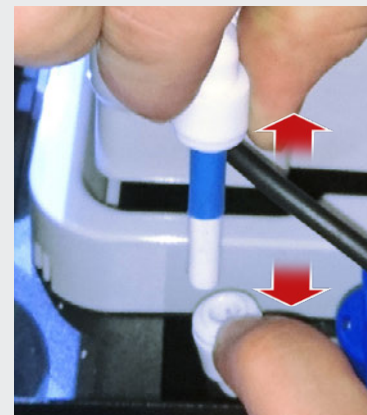
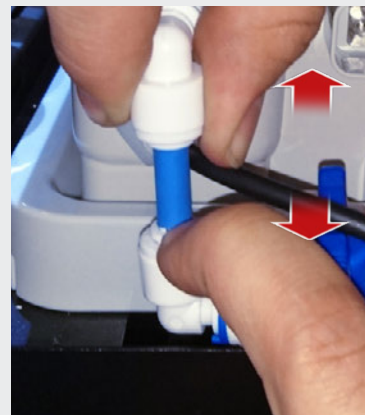

**13** The piping unit feed can also be used without a puller from the sump connector by pressing the fuse ring e.g. press down with the fingernail, unlock and pull the sump with the Bio-Fluid line at the same time.



**14** Now the sump can be lifted up from the burner.



**15** Repeat point **2 to 14** for all other sumps of the Endless effect burner.

# Endless effect burner

Installation options  
for the Endless  
effect burner in  
a THE FLAME  
Endless Fire Box



**16 Front-mounting option**  
Endless Fire Box (flange flush, flange protruding).

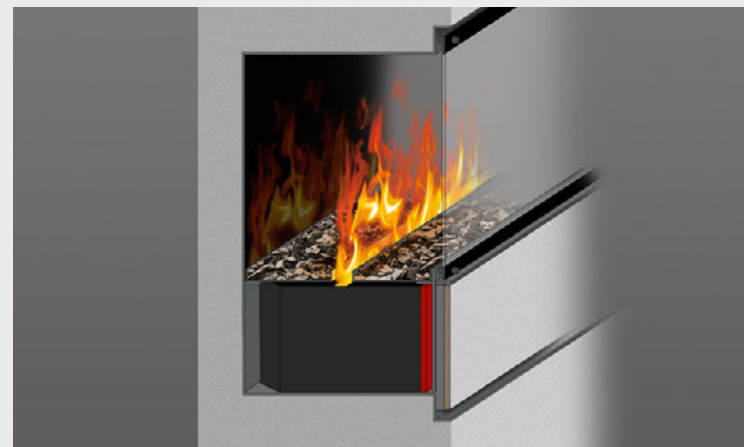

**17 Front-mounting option (cut)**



**18 Tunnel mounting option**  
Endless Fire Box (flange flush, flange protruding).



**19 Tunnel mounting option (cut)**

# Endless effect burner

Installation options  
for the Endless  
effect burner in  
a THE FLAME  
Endless Fire Box



**20 2-sided mounting option**  
Endless Fire Box (flange flush, flange protruding).

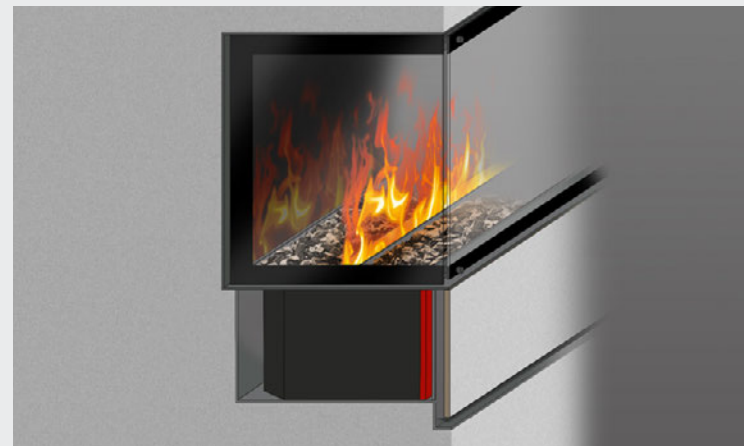

**21 2-sided mounting option (cut)**



**22 3-sided mounting option (long-short-long)**  
Endless Fire Box (flange flush, flange protruding).



**23 3-sided mounting option (long-short-long) (cut)**

# Endless effect burner

Installation options  
for the Endless  
effect burner in  
a THE FLAME  
Endless Fire Box



**24 3-sided mounting option (short-long-short)**  
Endless Fire Box (flange flush, flange protruding).



**25 3-sided mounting option (short-long-short) (cut)**



**26 Standalone mounting option**  
Endless Fire Box with base (flange flush, flange protruding).



**27 Standalone mounting option (cut)**



# Endless effect burner

## Installation options for the Endless effect burner in a THE FLAME Endless Fire Box

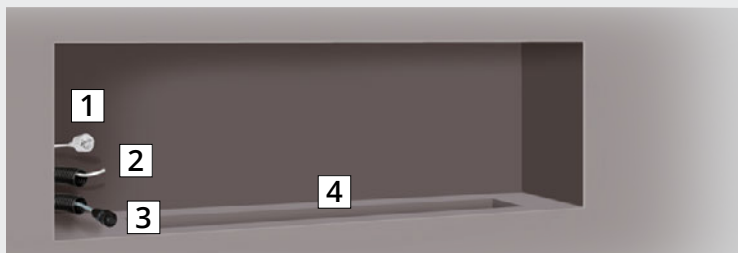

### 28 Preparation (on site) manual filling:

- 1 flexible power cable with current line plug and power connection 230 V

### Preparation (on site) fully automatic filling:

- 2 Osmosis water pipe from the O-Box (drawn in the empty pipe), min. ø25 mm
- 3 Power and control cable (5 x 1.5 mm², drawn in empty conduit)
- 4 Opening downwards for additional supply air



### 30 Endless Fire Box with drawer



### 29 Connection

#### Manual filling:

- Connection to the power supply

#### Fully automatic filling:

- Connection to the power and control line
- Connection to osmosis water pipe



### 31 Installation flush

- Insert in e.g. niche. The insert is inserted flush. Additional supply air from below via e.g. grilles is recommended.

# Endless effect burner

## Installation options for the Endless effect burner in a THE FLAME Endless Fire Box



**32** Additional supply air through grille, air slot or socket openings:

Endless 130:	400 cm <sup>2</sup>	Endless 330:	1.200 cm <sup>2</sup>
Endless 180:	600 cm <sup>2</sup>	Endless 380:	1.400 cm <sup>2</sup>
Endless 230:	800 cm <sup>2</sup>	Endless 430:	1.600 cm <sup>2</sup>
Endless 280:	1.000 cm <sup>2</sup>	Endless 480:	1.800 cm <sup>2</sup>

### Ambient air

Please note that effect fire systems are supplied with clean, purified air only. In the presence of chlorinated or salty air (e.g. pool, sea, etc.), the system must be tightly shielded from the ambient air. Fresh, clean air must be supplied mechanically from below. The fan of this external supply air must be speed controlled.

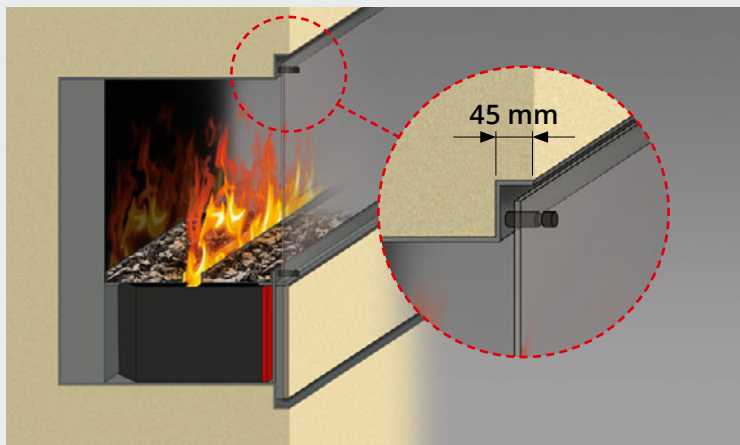

**33** Flange flush

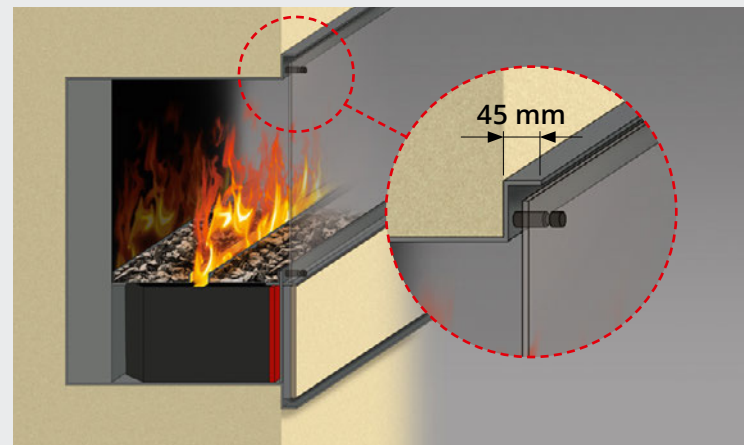

**34** Flange protruding

# Endless effect burner

Assembly for the  
Endless effect bur-  
ner in a THE FLAME  
Endless Fire Box

Position of the Endless effect burner  
in the Endless Fire Box:

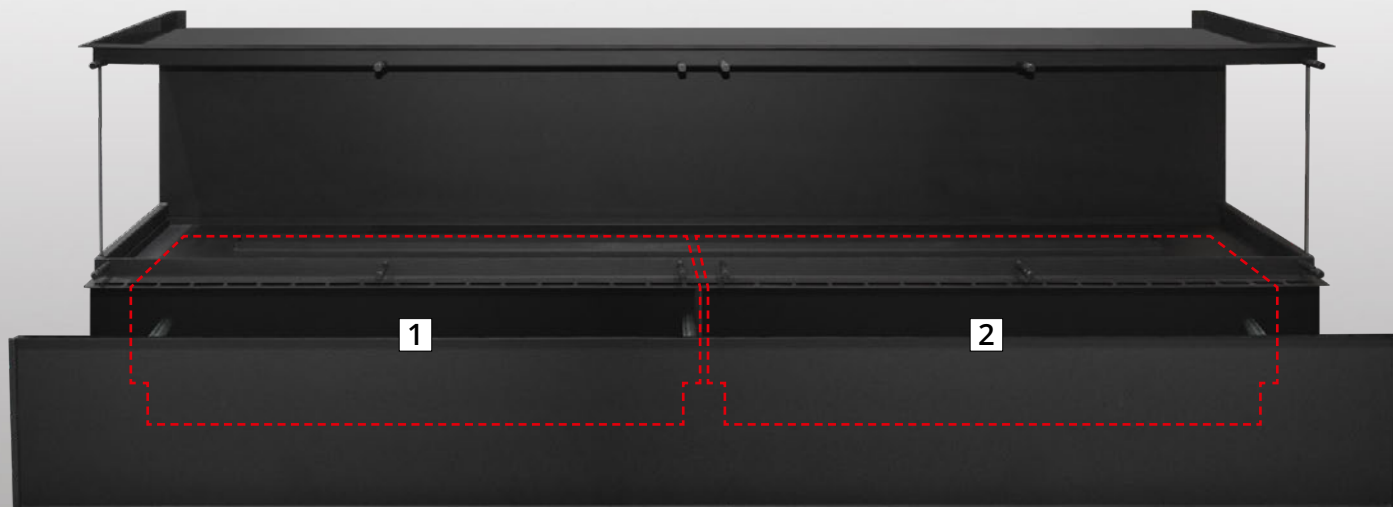

symbolic image

**Example:** Endless Firebox 200/230 - 3-sided (short-long-short)  
with 2 pcs. Endless effect burner 100

- 1 position for burner 1
  - 2 position for burner 2
- For further burners continue ascending to the right.

# Endless effect burner

Installation for the fully automatic operation (Fluidmatic) in combination with O-Box.

Requirement of it is the preparation of the cables from the O-Box. See the installation and assembly instructions from O-Box.



Installation for the manual operation without Fluidmatic and O-Box.

When using the **manual operation** or for manual filling please continue at point 62

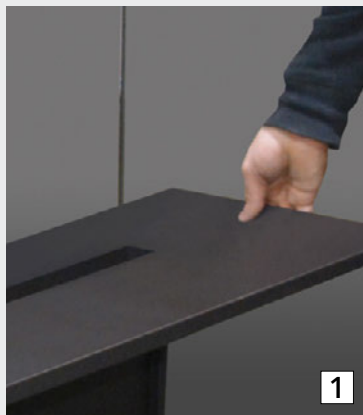

1

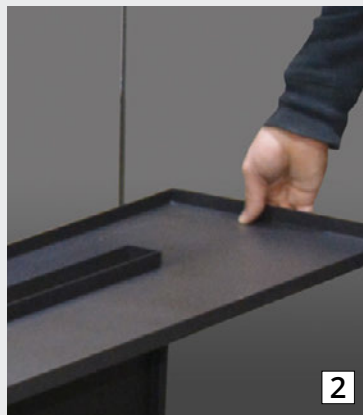

2

- 35 1 Cover (simple) - black, without stones  
2 Stone cover (turned cover) - with stones  
Remove the cover or stone cover of the Endless Fire Box.



O-Box

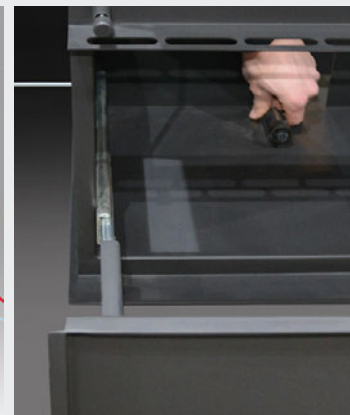

- 36 Put the 5-pin power and control cable (coming from the O-Box) with the standard round-plug (female) ahead from behind through the opening from the Endless Fire Box (left, down).



- 37 If your system is equipped with several burners, then put the connection control cable with the standard round-plug (female) ahead from left under the Endless Fire Box.

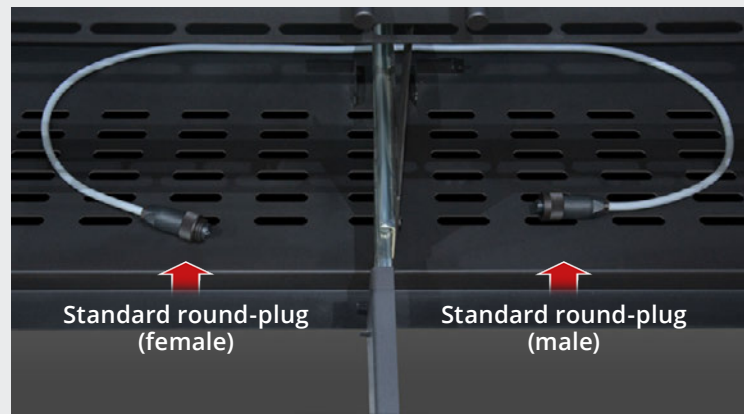

- 38 Here you can see the right position for the connection control cable. If your system is equipped with several burners, then repeat this process also in the area of the next service load.



# Endless effect burner

Installation for the fully automatic operation (Fluidmatic) in combination with O-Box

See the installation and assembly instructions from O-Box.

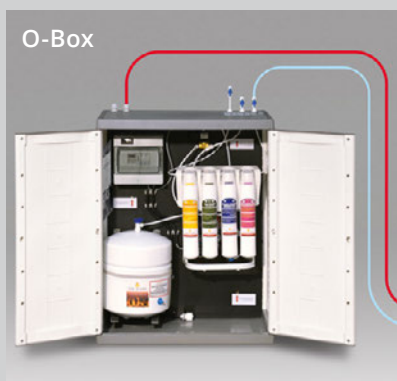

**39** Put the bio-fluid-cable (**coming from the O-Box**) at the backside through the opening from the Endless Fire Box (left, bottom).

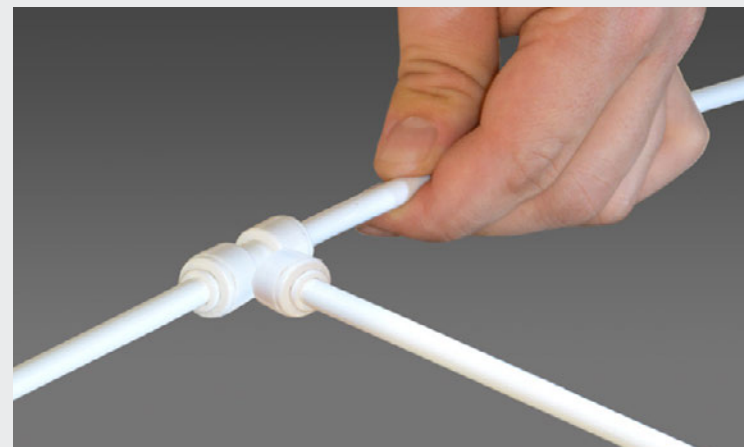

**40** If your system is equipped with several burners, then put the Bio-Fluid-cable with a T-piece until the next burner.

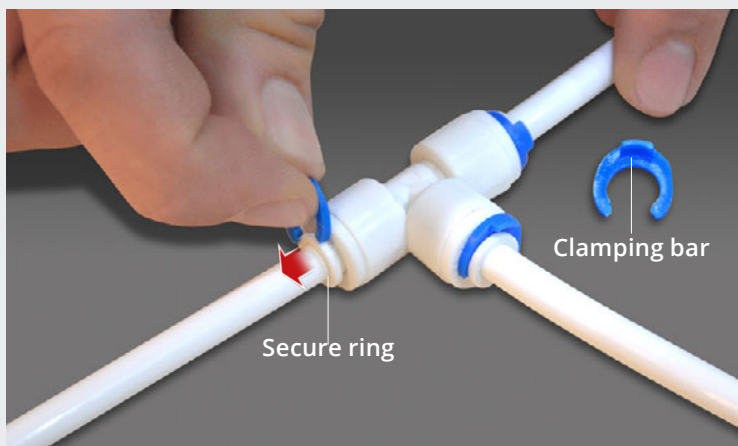

**41** Fixing the T-piece with the supplied blue clamping bars. First push the secure ring from the T-piece away and then set the clamping bar.

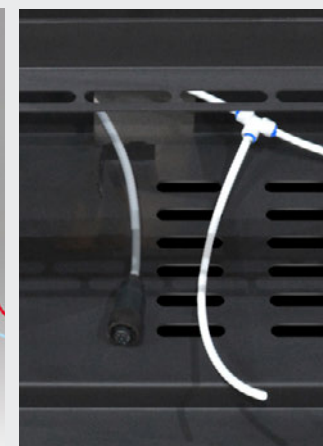
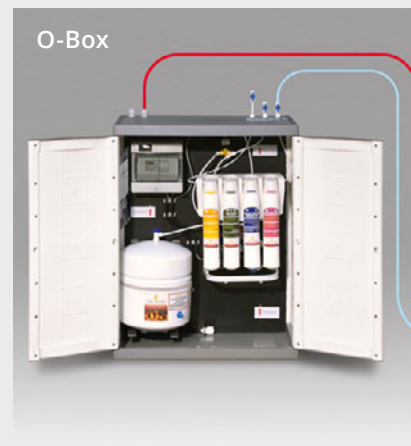

**42** Here you see the right handling with the Bio-Fluid-cable incl. T-piece and the 5-pol-control cable.

# Endless effect burner

Installation for the fully automatic operation (Fluidmatic) in combination with O-Box

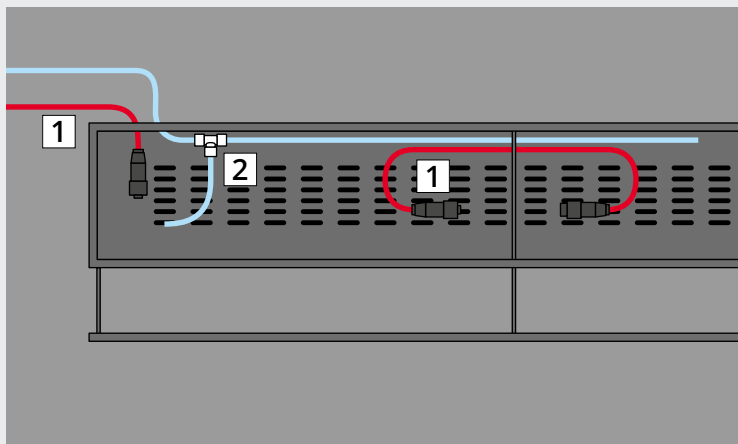

**43** Correct position of the power and control cables **1**, and the Bio-Fluid line **2**

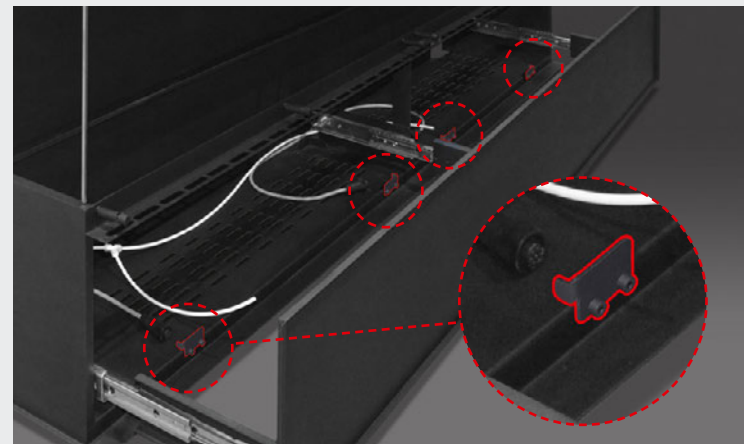

**44** Open the front drawer of the Endless Fire Box and remove all front burner brackets.



**45** Insert the Endless effect burner **1**. Make sure that the cables and hoses are freely accessible behind the burner.



**46** Push the Endless effect burner all the way to the right, until it touches the center plate.

# Endless effect burner

Installation for the fully automatic operation (Fluidmatic) in combination with O-Box

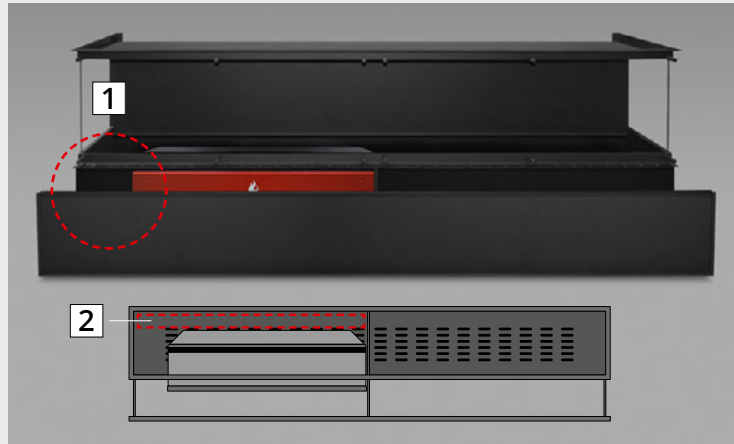

- 47** 1 Few more steps are necessary in this area.  
2 That area behind the effect burner must be free from the cable at this time.



- 48** Now lead the power and control cable (connecting cable to the O-Box) with the standard round plug (female) first, which is located to the left of the burner, from behind through the opening into the housing of the Endless effect burner (left, bottom)



- 49** Open the service load from the Endless effect burner that you can reach the connections. The control cable tuck in the connection "Power IN".

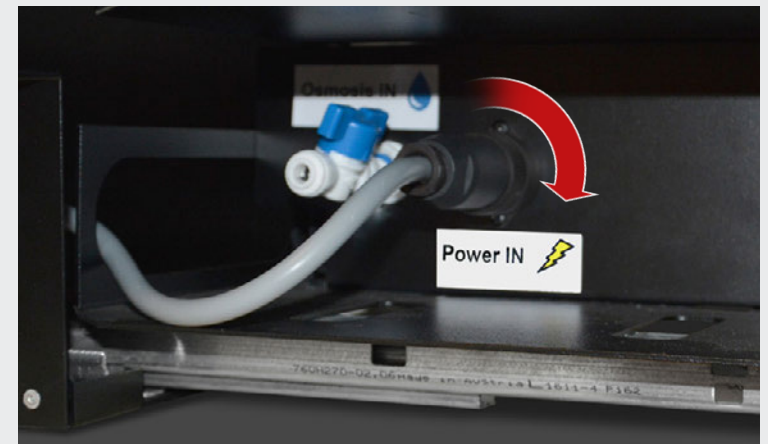

- 50** With a turn right the cable can be fixed.

# Endless effect burner

Installation for the fully automatic operation (Fluidmatic) in combination with O-Box



**51** Put the left sided Bio-Fluid-cable from the backside through the opening in the casing from the Endless effect burner (left, bottom).



**53** Close the service load and push the Endless effect burner to the left side until it hits the side load.

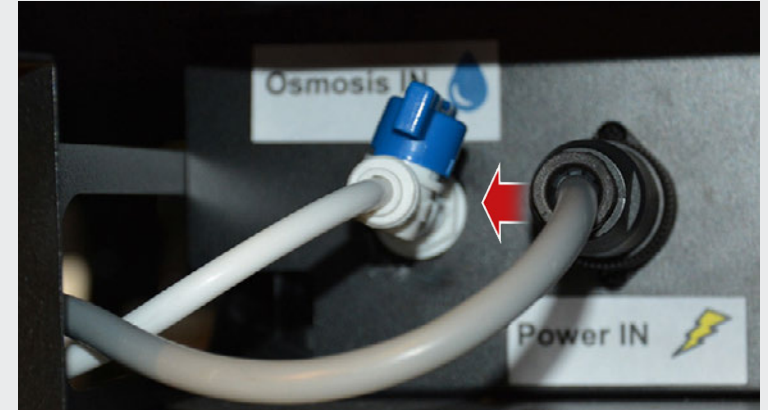

**52** Connect the Bio-Fluid line to the marked connection "Osmosis IN" until the stop is felt. Open the blue valve. If your system has only one burner please continue at point **58**.



# Endless effect burner

Installation for the fully automatic operation (Fluidmatic) in combination with O-Box



**54** 1 Few more steps are necessary in this area.



**55** Put the connection control cable (right side of the burner) with the standard round-plug (male) from the backside in the case of the Endless effect burner (back, right, down).



**56** Open the service load from the Endless effect burner and tack the connection control cable in the connection "Power OUT".  
1 Drain tap for emptying the safety tub.

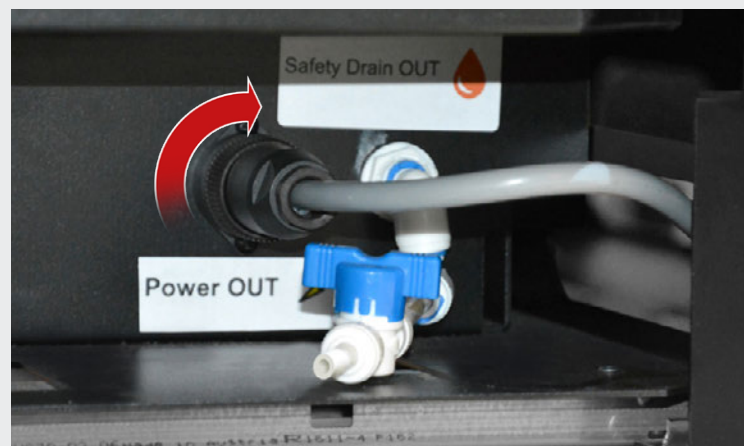

**57** With a turn right the cable can be fixed.

# Endless effect burner

Installation for the fully automatic operation (Fluidmatic) in combination with O-Box

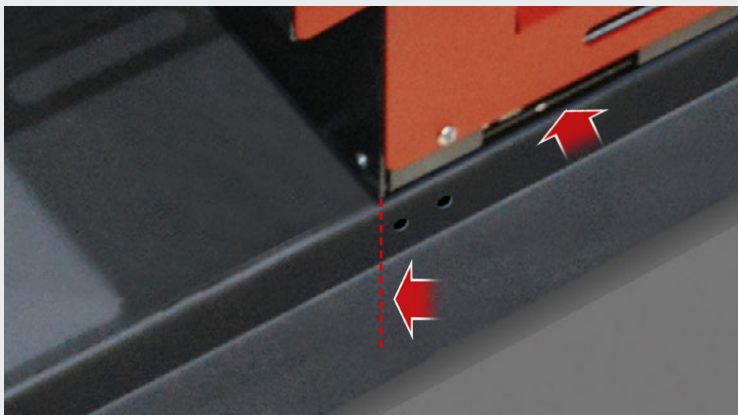

**58** Close the service drawer of the Endless effect burner again. Position it in relation to the holes in the front burner mountings and push the Endless effect burner all the way to the back.

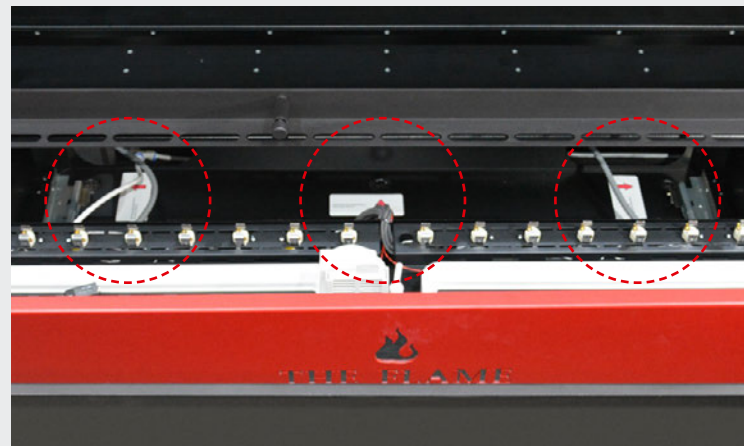

**59 Optionally**, the Endless effect burner can be screwed into the Endless fire box. The fixing points are marked. To do this, open the service drawer.

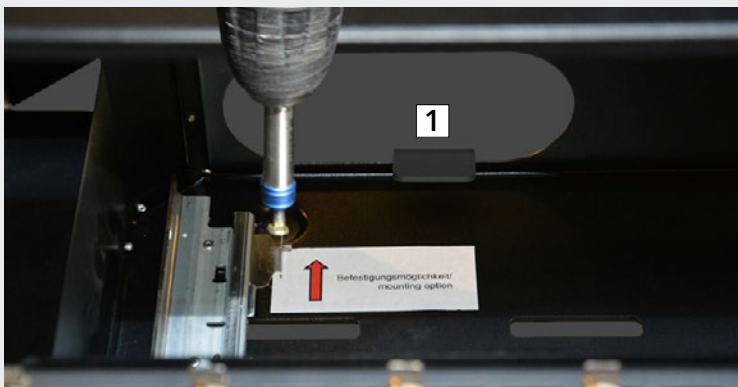

**60** Screw the Endless effect burner to the Endless fire box at the appropriate fixing points. Use self-tapping screws for steel 3.5 x 16 mm (or similar in length and diameter).  
**1** rear bracket.



**61** If your system is equipped with only one burner, please mount the front burner brackets and continue at number **75**. If your Effect fire box has more than one burner, then place the next Endless effect burner in the Endless fire box.

# Endless effect burner

Installation for the fully automatic operation (Fluidmatic) in combination with O-Box

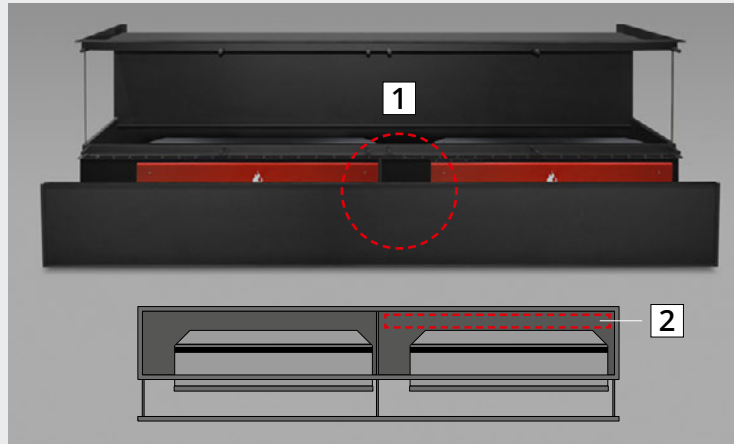

- 62** 1 Few more steps are necessary in this area.  
2 That area behind the effect burner must be free from the cable at this time.



- 63** Please pay attention that the cables are freely accessible behind the burner. Push the burner to the right side.



- 64** Put the connection control cable with the standard round-plug (female) from the backside through the second opening from the Endless effect burner (left, down) in the housing of the Endless effect burner.

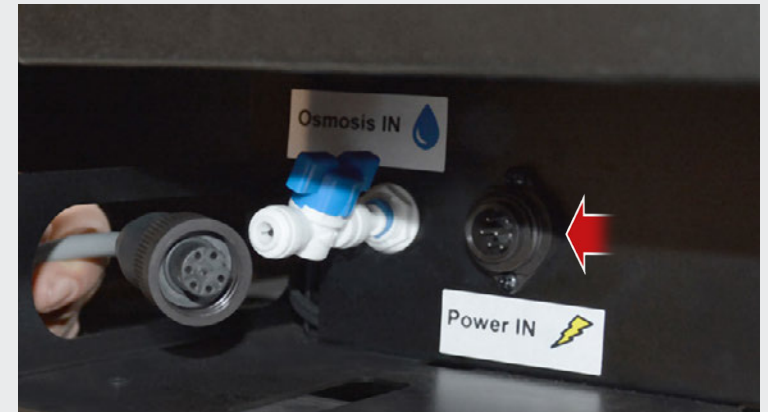

- 65** Open the service load from the Endless effect burner that you can reach the connections. The connection control cable tuck in the connection "Power IN".

# Endless effect burner

Installation for the fully automatic operation (Fluidmatic) in combination with O-Box

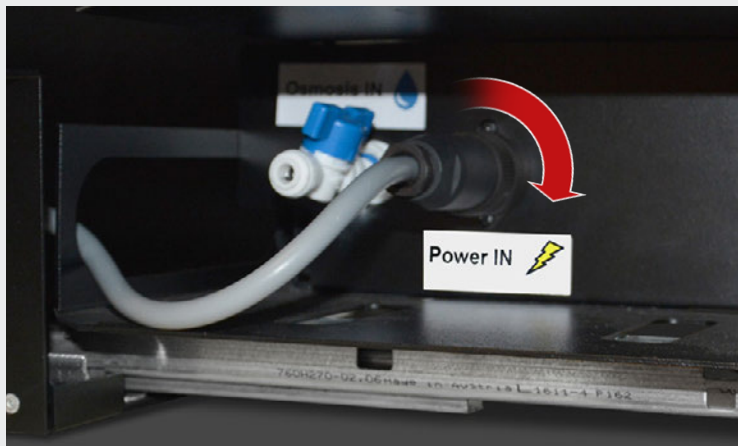

**66** With a turn right the cable can be fixed.



**67** Put the second Bio-Fluid cable ending backwards through the opening from the Endless effect burner housing. (left, down) .

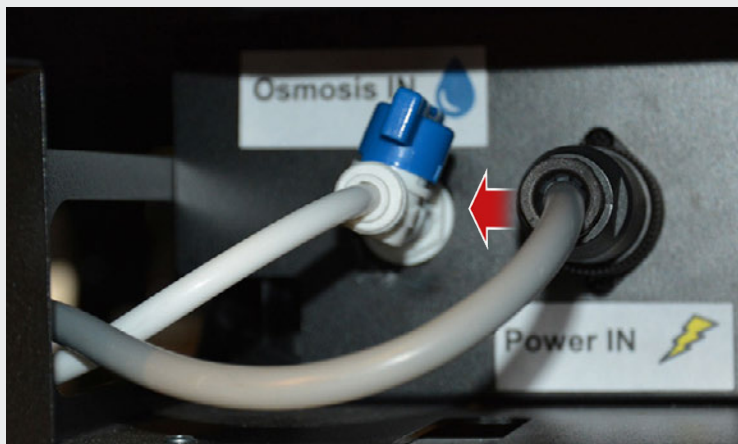

**68** The Bio-Fluid cable tuck in the connection "Osmosis IN". Please pay attention that the valve is open.

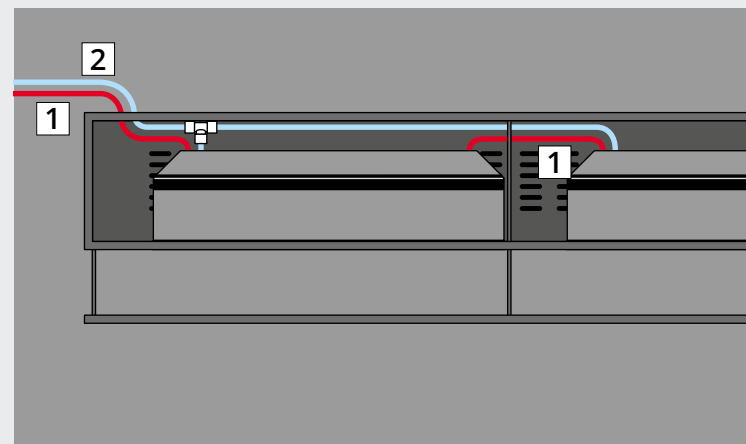

**69** Correct position of the power and control cables **1**, and the Bio-Fluid line **2**.



# Endless effect burner

Installation for the fully automatic operation (Fluidmatic) in combination with O-Box



Installation for the manual operation without Fluidmatic and O-Box



**70** When stringing together several Endless effect burners the flow part has to be removed at the contact points of the Endless effect burners (**not at the outer ends**). The flow part can be broken out using a pair of pliers.

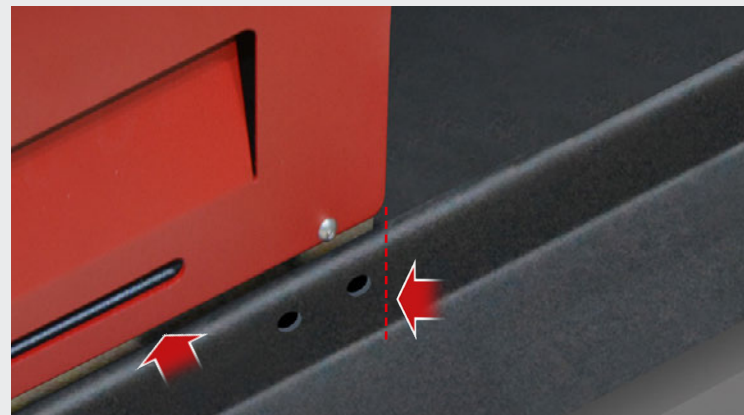

**71** Close the service drawer of the Endless effect burner again. Position it in relation to the holes in the front burner mountings and push the Endless effect burner all the way back.

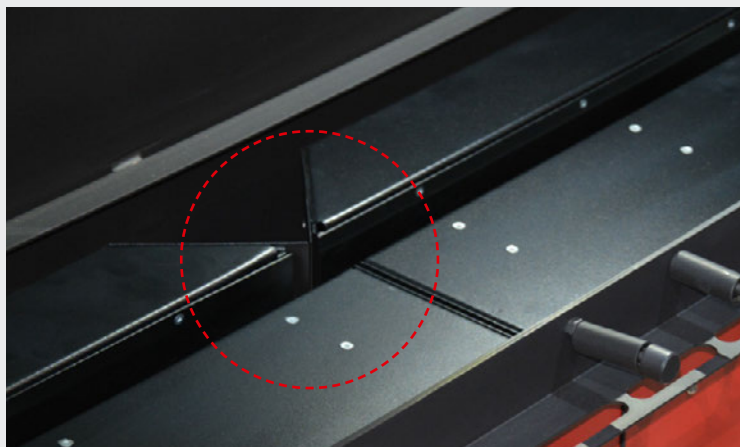

**72** Please check whether the transition in the fire slot of the connected burners is through.



**73** Now mount all front burner brackets.

# Endless effect burner

Installation for the fully automatic operation (Fluidmatic) in combination with O-Box

Installation for the manual operation without Fluidmatic and O-Box

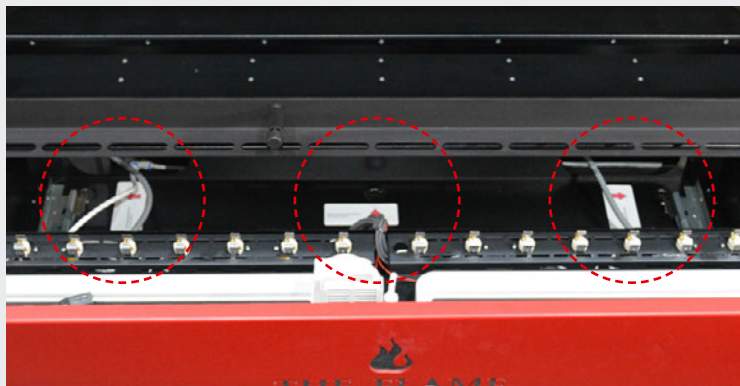

**74** Now the Endless effect burner can be fixed with the Endless Effect Fire Box. The fixing points are signed. Please open the service load. Use self-tapping screws for steel 3.5 x 16 mm (or similar in length and diameter).



If your system is equipped with several burners, then repeat the points 61 to 74 by all burners!

# Endless effect burner

Installation from  
the halogen spots,  
sump and water  
tank



**75** Now insert the halogen spots in the light bar. For a perfect colour sequence mix the spots. Perform this procedure on all Endless effect burners in your system.

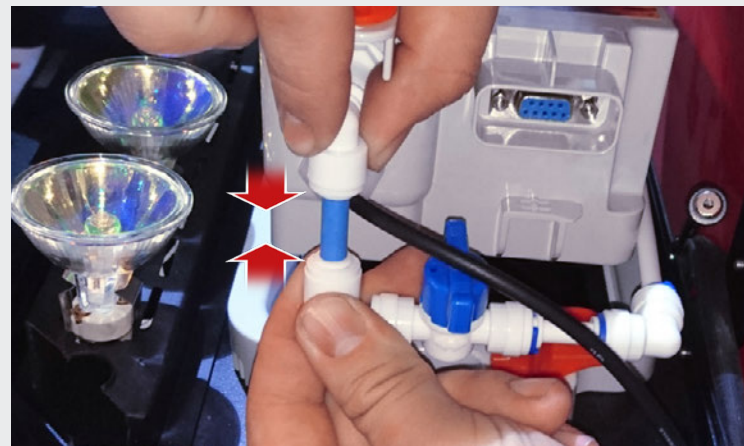

**76** The sump can be connected with the water connection. Please pay attention that the tube is inserted up to the mark.

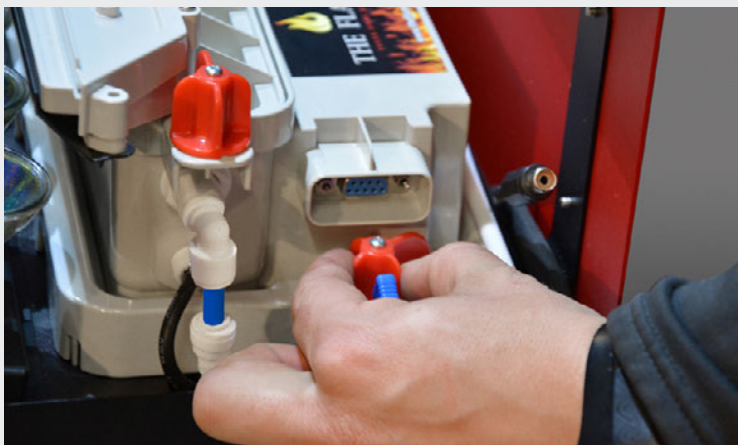

**77** Set in the sump and turn the both red handles (left and right on the sump holder) at the inside for fixing the sump.



**78** Plug the Cinch-plug again in the sensor line.



# Endless effect burner

Installation from  
the halogen spots,  
sump and water  
tank

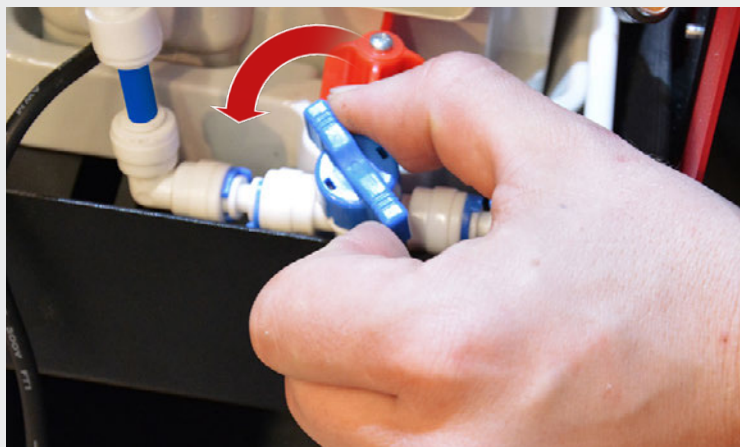

**79** Open the Bio-Fluid-cable valve with a turn against clockwise for 90°.

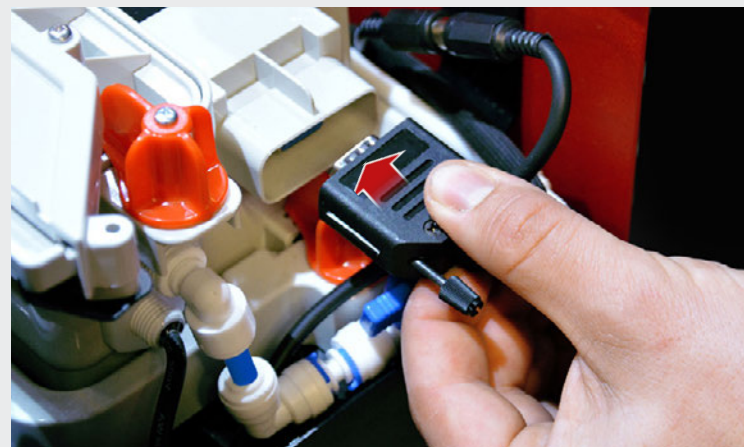

**80** Plug in the plug for the control cable again.



**81** Turn the both spin sticks on the plug.



**82** Please pay attention for a fine cable position. The cable are not allowed to get through the burner, so that the service load can easily closed. Repeat the points **75 to 82** with all the sumps.



# Endless effect burner

Installation from  
the halogen spots,  
sump and water  
tank



**83** With an automatic filling system from the O-Box the water tanks can be set in or they can be stored elsewhere. Close the service loads from the Endless effect burners.



**84** If your system works manual than fill all the water tanks with the Bio-Fluid or the distilled water. Close the service loads from the Endless effect burners.

## Tank cap

Closing the tank with the screw cap must be done very carefully and with normal, light force. It should be tight, but not closed with extreme force.

Capping with extreme force will damage the seal in the screw cap and lead to hairline cracks in the tank and screw cap. Hairline cracks and defective seals lead to uncontrolled leakage of water and thus to further damage.



# Endless effect burner

## Inserting the cover or stone cover

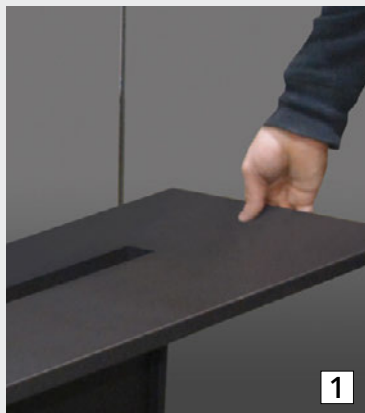

1

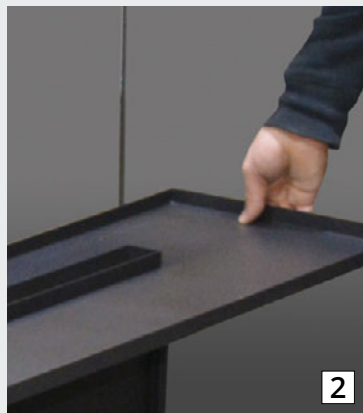

2

**85** 1 cover (simple) – black, without stones  
2 stone cover (turned cover) – with stones  
Place the cover or the stone cover in the Endless Fire Box.



**86** When use as a stone cover **2** the lava décor stones now can be filled in.



**87** Stone cover with stones and optional décor wood with glow effect.

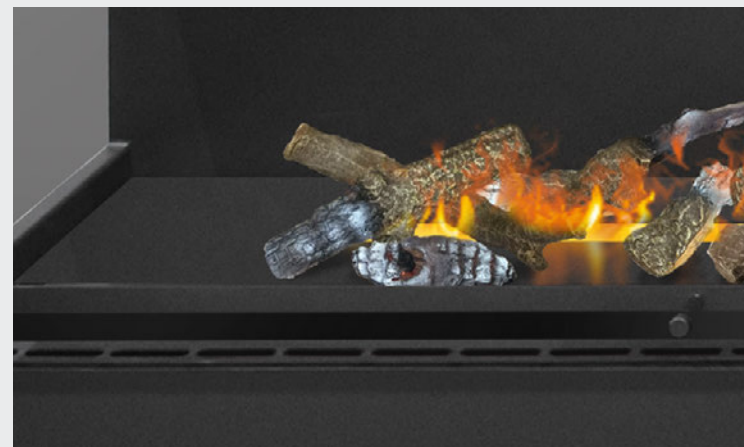

**88** Cover (simple) – black, without stones and with optional décor wood with glow effect.

# Endless effect burner

## Assembly of the glass cover



**89** Unscrew all Endless Fire Box glass mounting cylinders.



**90** Remove one PVC washer. Thus, a PVC washer remains behind the glass and one is placed in front of the glass.



**91** Using glass suction, lift the glass cover carefully onto the glass holder. Pay attention to the correct position of the drill holes in the glass. The wide black coating is at the top.

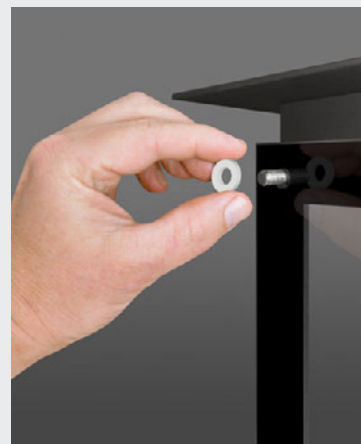

**92** Place one PVC washer on each glass holder and retighten all glass mounting cylinders.

# Endless effect burner

## Connection with the O-Box

- 1 O-Box housing with all connections prepared for the installation
- 2 reverse osmosis system with pump
- 3 water tank / container
- 4 control cabinet
- 5 3/2 way solenoid valve (flushing / filling the burner)
- 6 supply lines (fresh water)
- 7 Wastewater is guided in the outflow
- 8 osmosis compound to the Endless effect burners (Bio-Fluid cable)
- 9 floating switch (emergency stop - protection against overfilling in case of leakage)
- 10 tools for sensor exchange and filter changes, adapter 1/2" and 3/4", connection for sewage, TDS meter (measures the degree of purity of the water), operating instructions.
- 11 power supply 3 x 1.5 mm<sup>2</sup> protection: circuit breaker B13
- 12 control cable



**The main control cable and the osmosis line (Bio-Fluid line) of the Endless Fire Box are connected to the O-Box!**

**See operating instructions O-Box!**

**This point is no longer required for manual operation.**



# Endless effect burner

## Commissioning the Endless effect burner in the Endless Fire Box

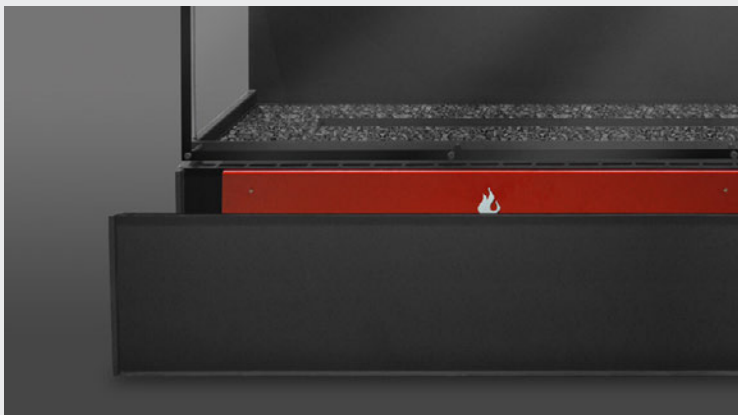

**93** As soon as the O-Box is in operation or the plug has been connected to the power supply with manual operation, the Endless system is ready for operation. Open the load of the Endless Fire Box.



**94** To turn on the Endless effect burner please switch the main control to "I".



**95** Turn the wheel to the lowest setting.

# Endless effect burner

## Commissioning the Endless effect burner in the Endless Fire Box

### Manual installation:

This can be operated at any time with the remote control as long as the burner is connected to the power supply.



### Automatic installation:

Setting the timer in the O-box (see the O-Box manual) or the external signal into the O-box. As long as the programming is running automatically, the remote control can only be used during this period. If the O-box is set to "ON", your device can be used with the remote control at any time (In this case, however, the O-box must be switched off and then switched on weekly so that the filters are rinsed).

During initial commissioning and after each cleaning, the technical unit (sump) is not filled with bio-fluid. As a result, it can take up to 30 minutes to reach the necessary Bio-Fluid level and start the burners.

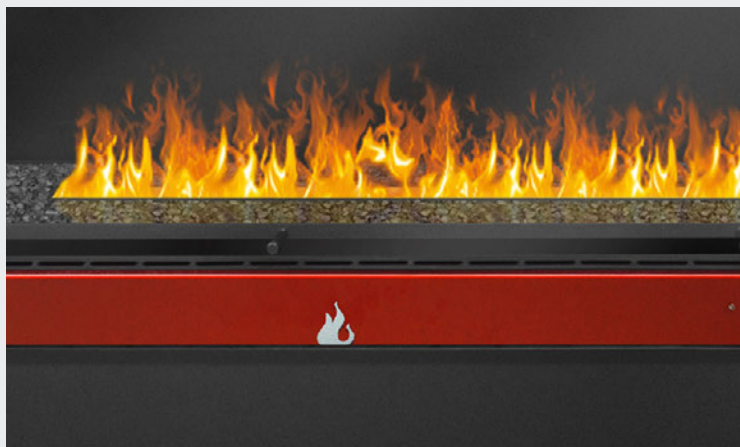

**97** After about 45 min. you can set the desired flame intensity as the device has reached the full operating temperature.

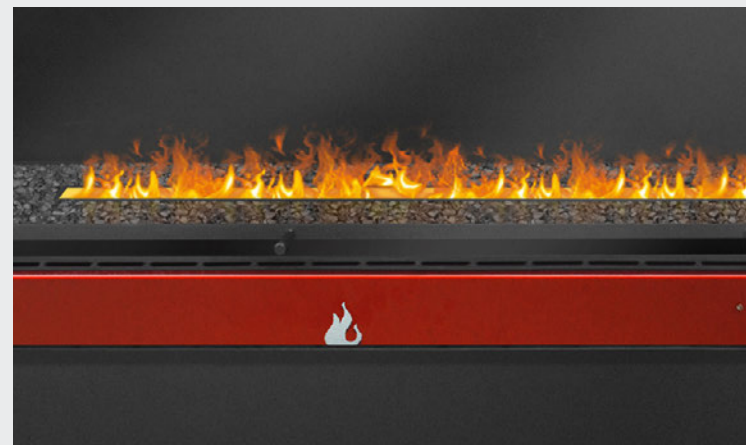

**96** As soon as the required bio-fluid level is reached (up to approx. 30 min.), the lamps start. After about 30 seconds, the flame effect starts.



**98** Turn the wheel to the desired level. Wait a few seconds until the desired flame effect is obtained.

**If the flame is too high, the glass starts to fog. Therefore, the flame must be set smaller until no more fitting is obtained. High flame only for open appliances.**



# Endless effect burner

## Coupling and controlling with the wireless touch remote control



**99** When the Endless effect burner is turned on. The LED on the built-in receiver will turn red.

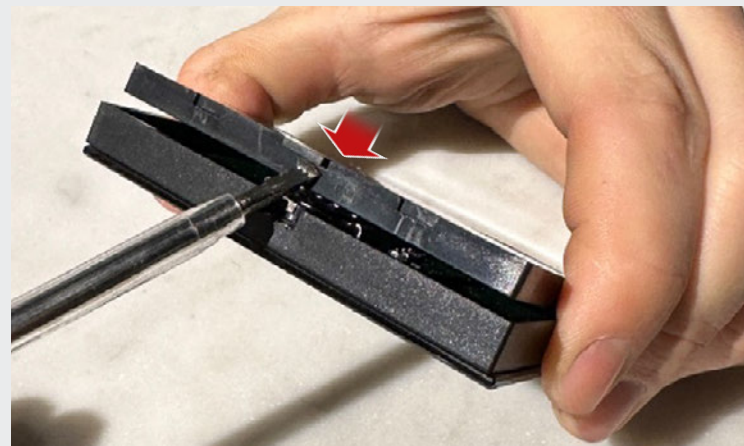

**100** To pair with the touch remote, press the RESET button twice in a row. The LED will start flashing blue additionally.

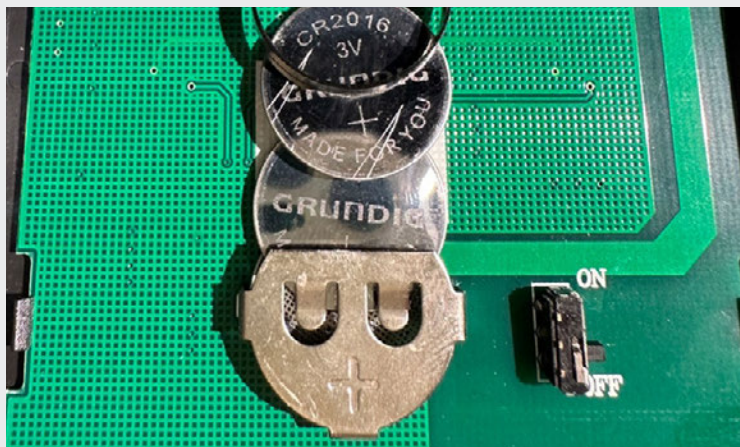

**101** Then press the ON/OFF switch on the wireless touch remote control. Now the remote control is "paired" and ready for use.

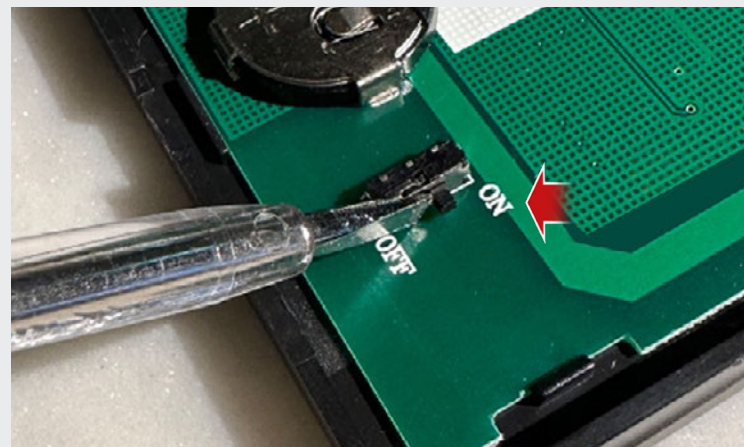

**102** To reset the remote control, press the RESET button 8 times in a row.



# Endless effect burner

## Coupling and controlling with the wireless touch remote control

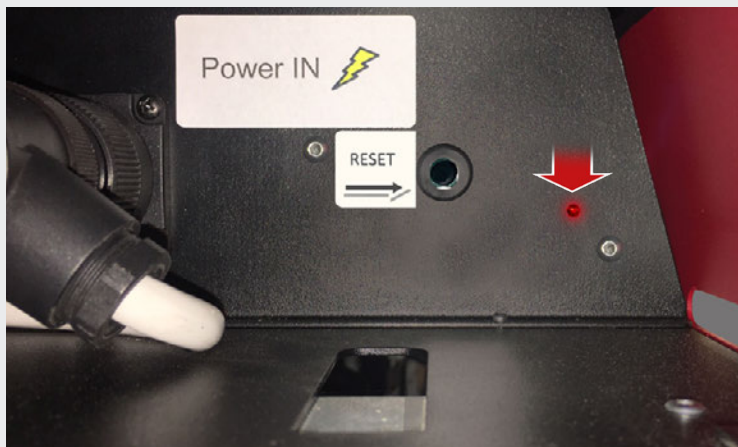

**99** When the Endless effect burner is turned on. The LED on the built-in receiver will turn red.

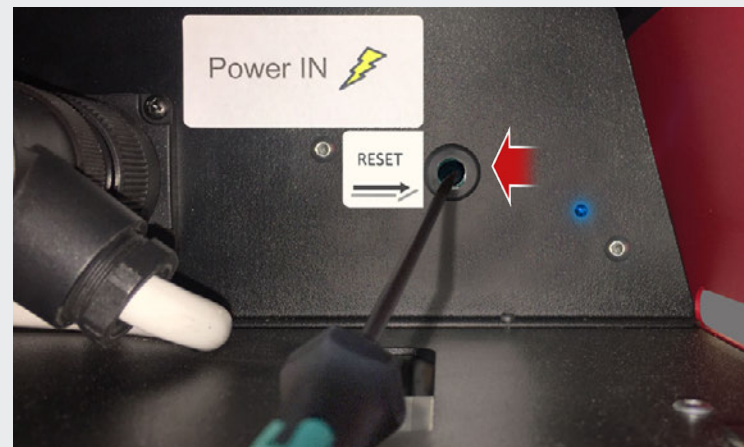

**100** To pair with the touch remote, press the RESET button twice in a row. The LED will start flashing blue additionally.



**101** Then press the ON/OFF switch on the wireless touch remote control. Now the remote control is "paired" and ready for use.

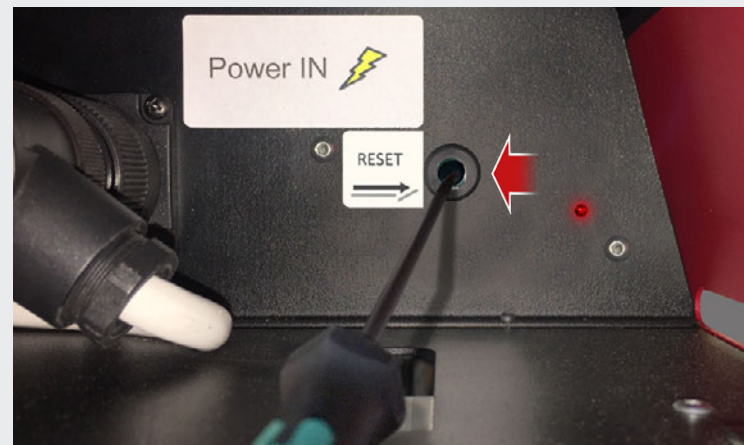

**102** To reset the remote control, press the RESET button 8 times in a row.



# Endless effect burner

## Discharging the overflowed/spilled Bio-Fluid from the collecting vessel

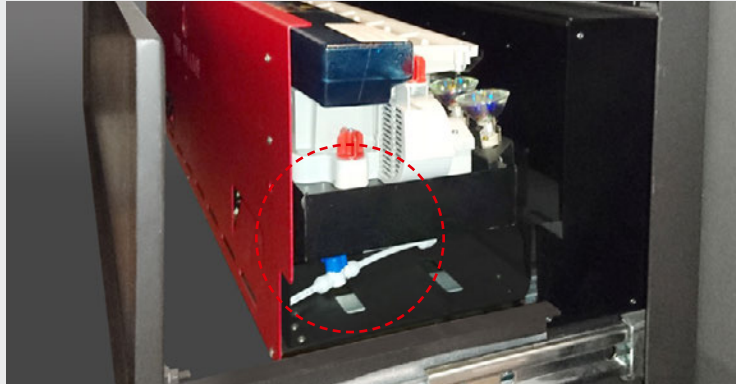

**103** In case of possible sump filling, leakage or spillage of Bio-Fluid, it flows into a safety basin under the sump. The O-Box switches off automatically (EMERGENCY-STOP) or all solenoid valves are switched off (closed).



**104** To unload, open the Endless Fire Box drawer and the Endless effect burner's service load. Bio-Fluid can now simply be drained off at the valve "Saftey Drain OUT" (located at each Endless effect burner).

## Note

### Operating time

Please note that a maximum continuous operating time (ON) of ten hours must not be exceeded. After ten hours of operation, the effect burner must be switched off for at least two hours (OFF) and can then be operated again for 10 hours (ON). Exceeding the maximum permitted continuous operating time (ON) of ten hours can lead to damage to technical components. Please note that any liability and warranty for damage or necessary repairs due to exceeding the operating time is void and rejected.



# Endless effect burner

## Maintenance and cleaning

### Maintenance and cleaning

Before cleaning the fire effect burner the mains plug must always be removed from the power socket. We recommend regular cleaning every 100 hours of operation or after 2 weeks at the latest (clearly, contamination/soiling should always be removed immediately). For general cleaning, always use a soft, clean dust cloth, without using scouring agents.

Please use **"CLEAN"**

from THE FLAME to clean the sump with the steam outlet nozzle. When cleaning off collected dust deposits and fluff, occasionally a vacuum cleaner with a soft brush attachment can be used to clean the outlet grill for the fan. The sump and tank are to be emptied and cleaned when the unit has not been used for more than 10 days.



**105** For cleaning, please use **"CLEAN"** from THE FLAME with a large brush, a sponge and a soft cloth.

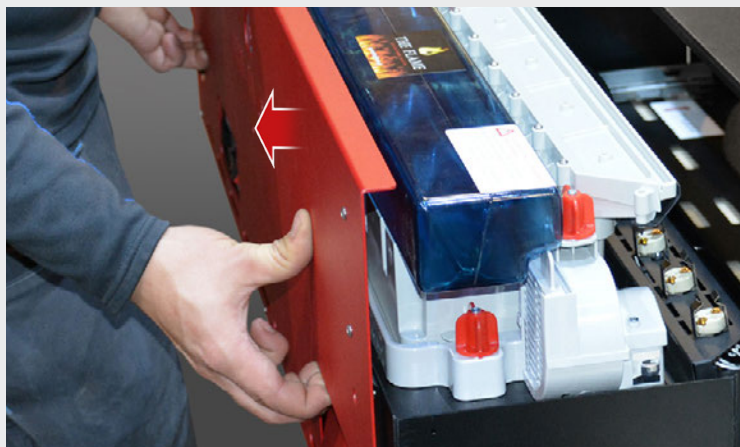

**106** Open the service load at the intended position handles.



**107** Remove the tanks for the manual filling.

# Endless effect burner

## Maintenance and cleaning

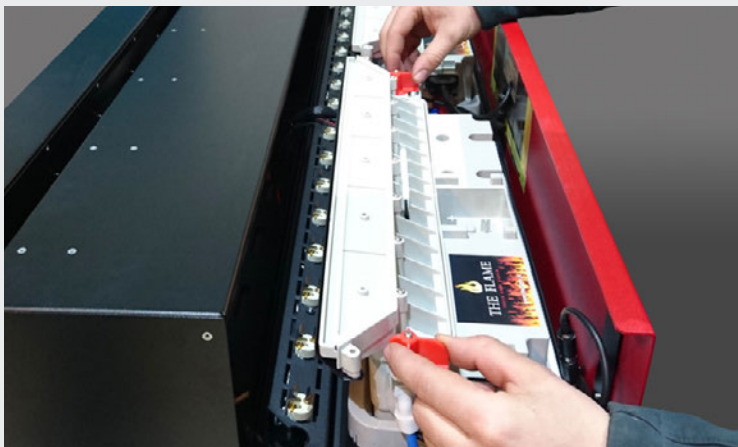

**108** Now turn the two upper, side, red handles (left and right on the plug-on nozzle) to the outside in order to be able to remove the plug-on nozzle.



**109** Now the plug-on nozzle can be removed from the technical unit (sump).



**110** Vigorously spray the attachment nozzle with **"CLEAN"** from all sides.



**111** Clean the nozzle with a sponge and rinse thoroughly with warm water. Then dry it with a soft cloth.



# Endless effect burner

## Maintenance and cleaning



**112** All plug connections must be removed from the sump. Open the two screwdrivers on the plug by turning against clockwise.



**113** Remove the plug.

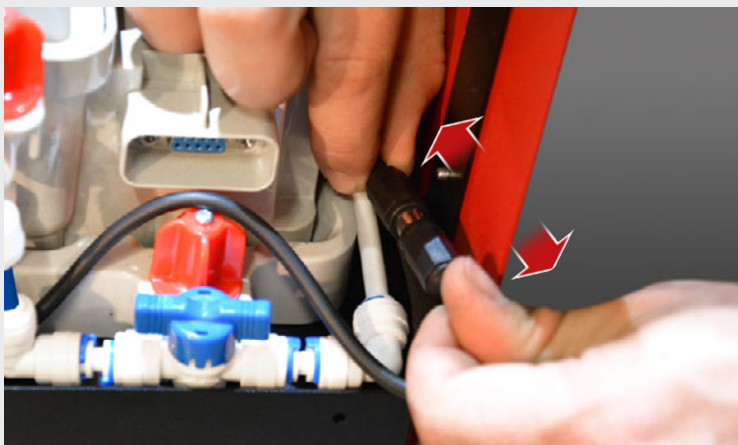

**114** Remove the plug-on nozzle from the sensor cable.

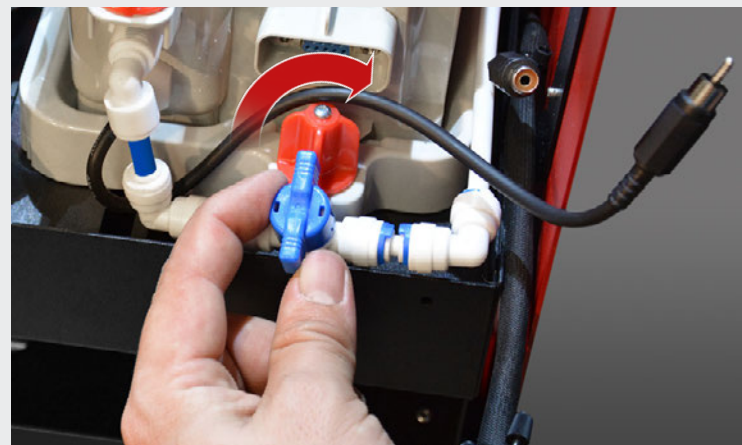

**115** Close the valve of the piping unit inlet by turning clockwise by 90 °.



# Endless effect burner

## Maintenance and cleaning



**116** Now turn the two lower, side, red handles (left and right on the sump holder) outside around the sump.

piping unit open

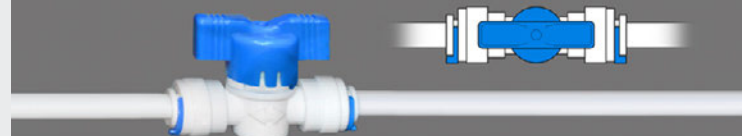

piping unit closed

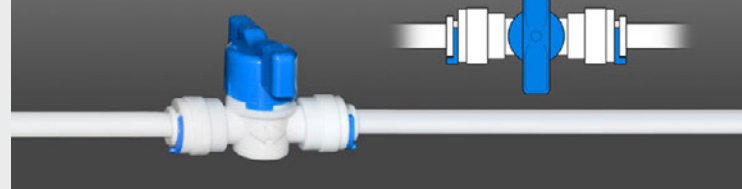

**117** Valve on the piping unit inlet open (top) and closed (bottom).

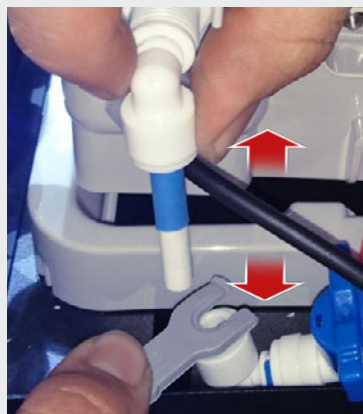
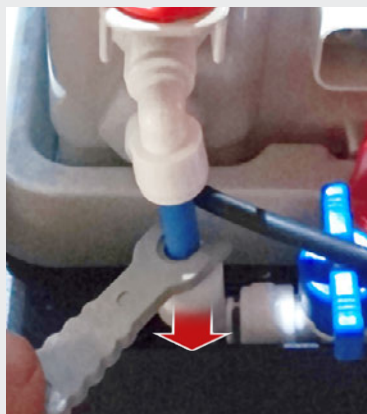

**118** You can use the puller (optional accessory) to remove the sump from the piping unit inlet with pull the safety ring downwards and bring up the sump with the Bio-Fluid line at the same time.



**119** The piping unit inlet is now separated from the sump.

# Endless effect burner

## Maintenance and cleaning

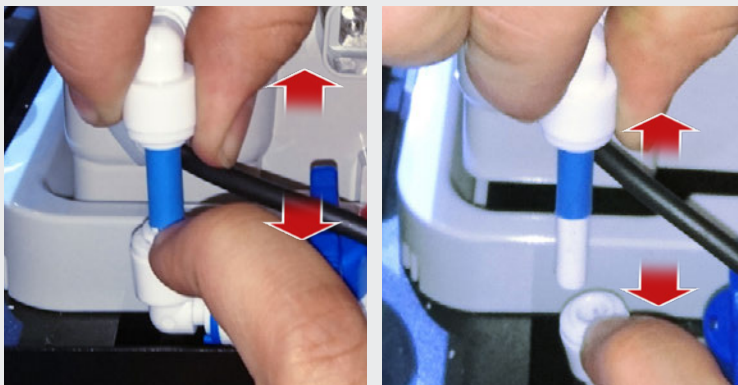

**120** The piping unit feed can also be used without a puller from the sump connector by pressing the fuse ring e.g. press down with the fingernail, unlock and pull the sump with the Bio-Fluid line at the same time.

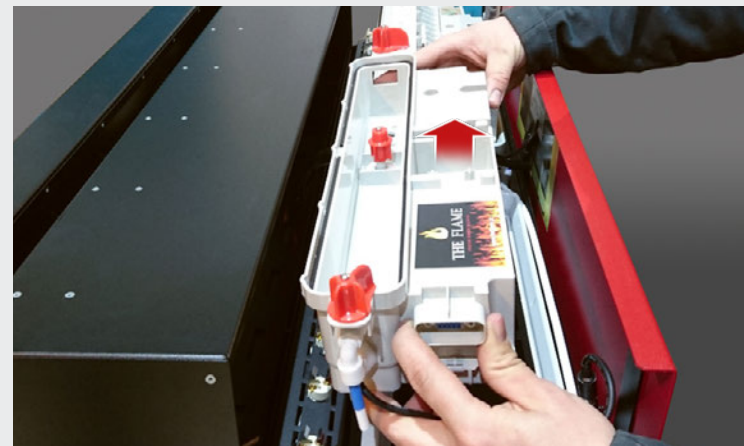

**121** Now the sump can be lifted up from the burner. Keep the sump as level as possible to prevent water from flowing out.



**122** Empty the sump and vigorously spray it with **"CLEAN"** from all sides.



**123** Clean the sump with a sponge. Make sure to carefully clean the ultrasonic membranes with the brush. Rinse the sump thoroughly with warm water and then dry it with a soft cloth.

# Endless effect burner

## Maintenance and cleaning



**124** Wipe the lamps over with a damp cloth.

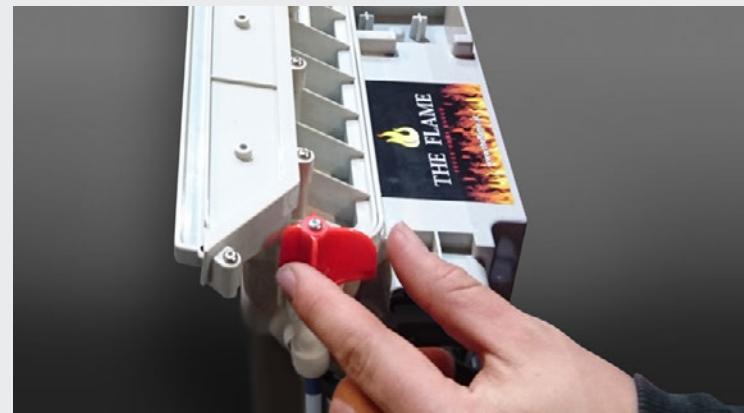

**125** Replace the nozzle on the technical unit (sump) and secure the upper red locking device on both sides.

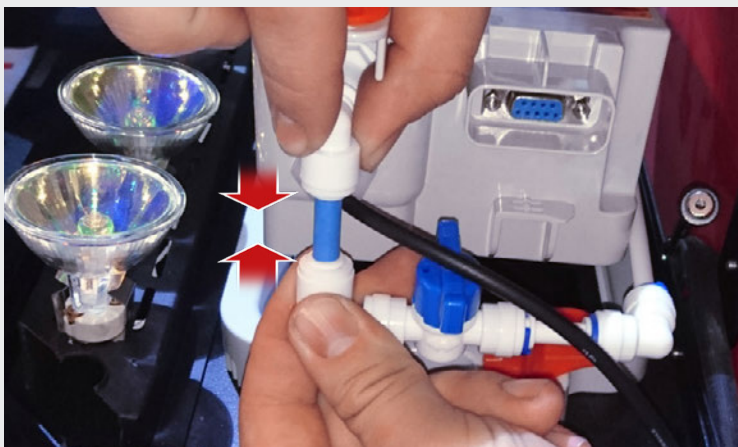

**126** The sump can be connected with the water connection. Please pay attention that the tube is inserted up to the mark.



**127** Set in the sump and turn the both red handles (left and right on the sump holder) at the inside for fixing the sump.



# Endless effect burner

## Maintenance and cleaning



**128** Plug the Cinch-plug again in the sensor line.



**129** Open the Bio-Fluid-cable valve with a turn against clock-wise for 90°.



**130** Plug in the plug for the control cable again.



**131** Turn the both spin sticks on the plug.



# Endless effect burner

## Maintenance and cleaning



**132** Please pay attention for a fine cable position. The cable are not allowed to get through the burner, so that the service load can easily closed.



**133** With an automatic filling system from the O-Box the water tanks can be set in or they can be stored elsewhere. Close the service loads from the Endless effect burners.



**134** If your system works manual than fill all the water tanks with the Bio-Fluid or the distilled water. Close the service loads from the Endless effect burners.

### Tank cap

Closing the tank with the screw cap must be done very carefully and with normal, light force. It should be tight, but not closed with extreme force.

Capping with extreme force will damage the seal in the screw cap and lead to hairline cracks in the tank and screw cap. Hairline cracks and defective seals lead to uncontrolled leakage of water and thus to further damage.

