

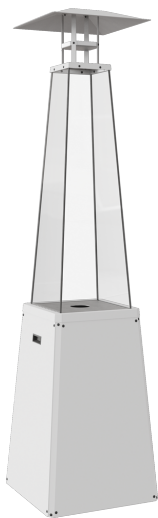

THE FLAME

infiring solutions



SIENA



Installation & Operation Manual



ATTENTION

HOT SURFACES CAN CAUSE BURNS.

**DO NOT TOUCH ANY WORKING SURFACE OF THE APPLIANCE
BEFORE IT IS COOLING DOWN.**

**NEVER LEAVE CHILDREN AND OTHER CONSCIOUS PEOPLE NEAR
THE WORKING APPLIANCE.**

WARNING!

THE DEVICE IS HOT DURING WORK!

AS A RESULT OF CONTACT WITH HOT DEVICE SURFACES, BURNS MAY CAUSE. CHILDREN, ELDERLY PEOPLE (OR OTHER PEOPLE REQUIRING CARE), ANIMALS, CLOTHES, FLAMMABLE FURNITURE, ANY FUEL OR OTHER FLAMMABLE MATERIALS SHOULD BE FAR AWAY FROM THE DEVICE.

REMEMBER TO CARE FOR THE MAINTENANCE OF THE APPLIANCE IN ACCORDANCE WITH THE RECOMMENDATIONS OF THIS MANUAL!

Read the instructions to the end and make them available to any possible user of the device before operating it.

Any modifications to the device are strictly prohibited. Never attempt to modify the device or any part of it. Any changes or modifications result in immediate loss of warranty and the validity of all device certificates.

The device must be installed and serviced only by a qualified installer.

Thank you for purchasing the SIENA gas garden heater. This device has been designed with your safety and comfort in mind. We express confidence that you will be satisfied with your choice due to the commitment we have put in the work on the design and production of this device. Please read these instructions carefully before installation and use. If you have any questions or concerns, please contact with our technical department. All additional information is available on our website www.the flame.at

The Flame is a well-known and respected manufacturer of heating devices both on the Austrian and European market. Our products are made on the basis of strict standards. Each garden heater manufactured by the company is subjected to factory quality control, during which it undergoes rigorous safety tests. Use of materials with the highest quality in the production guarantees smooth and reliable operation of the device to the end user.

This manual contains all the information necessary for the correct connection, operation and maintenance of the SIENA gas garden heater designed for use in an open or well ventilated space.

SIENA as a gas fueled device is an open device, without an exhaust system, intended for heating exposed and / or ventilated surfaces. Very low emission factors guarantee safety even when used on small, ventilated covered surfaces. The heater meets the strict requirements of European directives regarding safety and the environment. The device has been designed and tested in accordance with PN-EN 14543 Requirements for devices burning liquefied hydrocarbon gases (C3-C4) - Terrace patio heaters - Radiators without a flue pipe, used outdoors or in a well-ventilated space. Read these instructions before installation and use. The information contained in it will allow for trouble-free use of the device. The manual should be kept for the whole lifetime of the device.

The SIENA gas garden heater has been designed for propane or propane butane gas mixtures. This device is available in several versions depending on the control options, type of glazing or color preferences. This device is equipped with a completely safe, advanced, manual gas control system with anti-tilt valve.

DIMENSIONS OF THE APPLIANCE

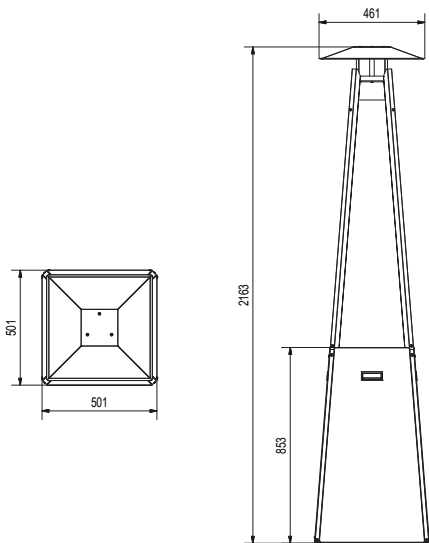

Fig. 1. Dimensional drawing of the SIENA versions.

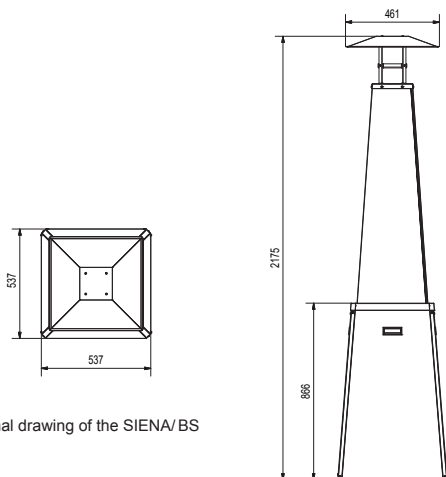

Fig. 2. Dimensional drawing of the SIENA/BS versions.

TECHNICAL SPECIFICATION

	Unit	Appliance category						
		I _{3P(30)}	I _{3P(37)}	I _{3P(50)}	I _{3B/P(30)}	I _{3B/P(37)}	I _{3B/P(50)}	I _{3+/(30/37)}
Reference gas	-	G31			G30			G30/G31
Nominal connection pressure	[mbar]	30	37	50	30	37	50	30/37
Gas pressure per burner for nominal (maximum) load		30	37	50	30	37	50	30/37
Nominal (maximum) heat load, according to H _g		12						
Minimal heat load, according to H _g		3,1	3,9	4,0	3,9	3,9	4,8	3,9
Gas flow	m ³ /h	0,491	0,404	0,445	0,314	0,327	0,333	0,314 / 0,404
Usage of gas	g/h	0,899	0,739	0,814	0,575	0,598	0,609	0,575 / 0,739
Gas nozzle mark	[mm]	1,90	1,70	1,60	1,70	1,60	1,50	1,70
	-	LPG	LPG	LPG	LPG	LPG	LPG	LPG 1.70

Table 1. Technical specification - SIENA

Manufacturer details:

Manufacturer: THE FLAME GMBH
Contact details: Schalsersstraße 41
A-6200 Jenbach
tel. +43 5244 62592
fax +43 5244 62592 16
www.theflame.at
European Standard EN 14543

INSTALLATION

SIENA GAS OUTDOOR HEATER MUST BE INSTALLED AND / OR SERVICED BY A QUALIFIED SPECIALIST. DO NOT ATTEMPT TO MODIFY THE CONSTRUCTION OF THE DEVICE OR ITS COMPONENTS. ANY MODIFICATION WILL CAUSE IMMEDIATE LOSS OF WARRANTIES AND CERTIFICATES.

PLEASE NOTE: AVOID THE RECOMMENDATIONS OF THESE INSTRUCTIONS WITH REGARD TO INSTALLATION, OPERATION OR AVOIDING THE RECOMMENDATIONS CONCERNING AUTHORIZED PARTS AND ACCESSORIES FOR THIS APPLIANCE MAY RESULT IN SERIOUS INJURIES OR DAMAGE TO PROPERTY.

THIS APPLIANCE HAS BEEN DESIGNED IN ACCORDANCE WITH RESTRICTED SAFETY STANDARDS AND RECOMMENDED. IT WAS TESTED AND CERTIFIED BY A NOTIFIED BODY ACCORDING TO EN 14543.

GENERAL INFORMATION / IMPORTANT: KEEP THESE INSTRUCTIONS!

It is important to periodically check the proper functioning and integrity of individual components of the gas control system, as well as structural elements for any damage. It is very important that the gas control system remains intact and free from any damage. The device can be serviced only by a qualified technician with appropriate qualifications. Failure to comply with these rules may result in serious health damage and even death and property damage.

Installation and use must be carried out in accordance with national building regulations. Your authorized dealer can help you determine what safety precautions should be taken when installing or using the device. In some cases, you may need to obtain permission to install or operate such a device. Always consult an authorized dealer or building inspector to determine which regulations apply to the use and / or installation of the device in your area. In the absence of provisions governing installation and use, it is essential to comply with the instructions in the manual and the fire safety code.

Do not switch on the device if any of its components has been previously dismantled, damaged or destroyed. Before reuse, the missing or damaged part must be replaced by the original replacement provided by the manufacturer.

If the device, especially gas control system components or the burner has been flooded, switch off the device and consult a technical department or a qualified serviceman in order to check whether the reuse will require replacement of any of the system components.

SAFETY INFORMATION

The device is for external use only or for use in a well ventilated areas!

A well-ventilated space must have 25% of its surface exposed. This area is determined on the basis of the sum of the wall surfaces of the given usable space.

Due to the possibility of high temperatures of all surfaces of gas garden fireplaces and due to possible exposition to the fire, all flammable materials should be located at a safe distance from the device.

Elderly people, children and other unconscious persons should be informed and warned of the possibility of high temperatures occurring on the appliance during its operation and immediately after it is extinguished, and should avoid contact with the appliance to prevent burns and ignition of clothing.

Children, infants, infirm people and other people who require special attention that can be close the appliance should be subject to special supervision. These persons may be particularly exposed to accidental contact with the appliance. If necessary, use safety barriers to limit access to the appliance.

NEVER obstruct THE VENTILATION ROOM OF A GAS CYLINDER!

Do not hit or lean against any part of the appliance.

ATTENTION: No elements in the appliance may be replaced by other parts than those provided by the manufacturer or recommended by the manufacturer.

Use only the gas type and gas cylinder type specified by the manufacturer. In case of strong wind, protect the device against gusts or turn it off.

Under no circumstances any of solid fuels (wood, paper, coal, etc.) shall be used in this appliance.

IT IS STRICTLY PROHIBITED to use any liquid fuels or other flammable materials to light the appliance!

To avoid accidents, it is not recommended to allow the use of the device to persons not familiar with the operation of the device. For safety, always use gloves and goggles for maintenance.

WARNING!

- Always make sure that the gas supply is cut off before checking, servicing or cleaning the device.

SET COMPONENTS - FIRST UNPACKING OF THE PURCHASED HEATER

If any damage or deficiencies are noticed during the consignment inspection, please contact your authorized dealer.

Please make sure that all parts of the set are not damaged during transport. The check should take place in the presence of the courier. The purchased heater should contain a complete gas cylinder connection kit.

- A complete, ready-to-use burner with a full gas control system armed with a manual controller.
- Installation and operating instructions.
- Windows, doors, cap and other masking elements for self-assembly.

It is necessary to buy and install a correct pressure regulator and gas hose to connect the appliance to the gas cylinder. The choice of the regulator shall be made in accordance with the specification note in the table below or on a rating label (choose the pressure according to the ticked box).

Version	Category		Pressure/Gas	
Siena <input type="checkbox"/>	I3B/P	<input type="checkbox"/>	30 mbar, G30	<input type="checkbox"/>
			37 mbar, G30	<input type="checkbox"/>
			50 mbar, G30	<input type="checkbox"/>
Siena / BS <input type="checkbox"/>	I3P	<input type="checkbox"/>	30 mbar, G31	<input type="checkbox"/>
			37 mbar, G31	<input type="checkbox"/>
			50 mbar, G31	<input type="checkbox"/>
	I3+	<input type="checkbox"/>	28-30/37 mbar, G30/ G31	<input type="checkbox"/>

The regulator has to be compliant with requirements of EN 16129 Pressure regulators, automatic change-over devices, having a maximum regulated pressure of 4 bar, with a maximum capacity of 150 kg/h, associated safety devices and adaptors for butane, propane, and their mixtures and it should have a valid CE and GAR compliance Certificate!

The hose has to be at least 60 cm long and it has to be compliant with EN 16436 Rubber and plastics hoses, tubing and assemblies for use with propane and butane and their mixtures in the vapour phase. Hoses and tubings!

ATTENTION: Picking up the wrong pressure while choosing the regulator may lead to incorrect

combustion, smoking or even may cause health problems. Never connect the wrong pressure regulator for connection of the appliance to the gas supply than the one stated in table on page 7 or on your appliance's rating label.

The SIENA gas garden heater has been designed with your comfort in mind. The device is equipped with a modern gas control system protecting against uncontrolled gas leakage.

INSTALLATION - INTRODUCTION

Connection of a gas garden heater to liquefied gas cylinders, as well as its adjustment and checking the tightness of the installation should be made only by an authorized gas equipment installer or authorized service technician in accordance with applicable regulations, which should be confirmed on the product warranty card. Lack of such confirmation voids the warranty!

DEVICE INSTALLATION AND STORAGE OF BOTTLES SHOULD BE IN COMPLIANCE WITH APPLICABLE LAWS

NEVER USE ANY PARTS OF THE APPLIANCE NOT PROVIDED OR RECOMMENDED BY THE MANUFACTURER!

The device has an open combustion chamber without the option of connecting it to a chimney flue. The SIENA gas garden heater is sold with the pre-installed gas control system, however, before the first use it is recommended to check the tightness of the system due to the possibility of its unsealing in transport. All instructions on how to properly connect the system, installation in the table and frame can be found below in the following instructions.

NOTES ABOUT HANDLING:

This device is designed for easy installation and it is movable using the grips on sides of the appliance. Before moving it, make sure that all anti-removal components have been uninstalled, the gas supply has been cut off, and the hose is disconnected from the heater valve. Moving the device while it is in operation is strictly prohibited. After placing the heater in the desired place, secure it against slipping, falling out or falling over.

WARNING: DO NOT MOVE THE APPLIANCE WHEN IT IS IN OPERATION!

All European type GAS cylinders up to 11 kg weight and not wider than 33 cm or higher than 65 cm are compatible with the appliance.

INSTALLATION RULES

Installation should be carried out in accordance with the requirements of the law in force in the given country or region. In the absence of such provisions, the rules contained in this manual and the principles of fire safety should be followed.

This appliance has been tested for quality and safety and has been certified by a notified testing laboratory.

WARNING

The SIENA gas garden heater is adapted to work with a cylinder or a household tank of a propane-butane gas mixture. The flexible connection pipe should be intended for LPG from the cylinder.

The device is sold with complete automation and cables connecting the main burner and pilot burner with the valve controller. Do not use replacement system components other than those installed or supplied by the manufacturer.

ASSEMBLY OF THE APPLIANCE

The device should be assembled according to the diagram below. Skipping any step during installation may result in damage to the device during operation, and even the occurrence of dangerous situations that threaten the health of the users of the device.

SIENA VERSION

Step 1. The Base of the burner (2) shall be installed with the logo The Flame in the same direction as the hole in the base of the body (1). Then screw in the angles (13) with both burner base and body base as per the drawing below.

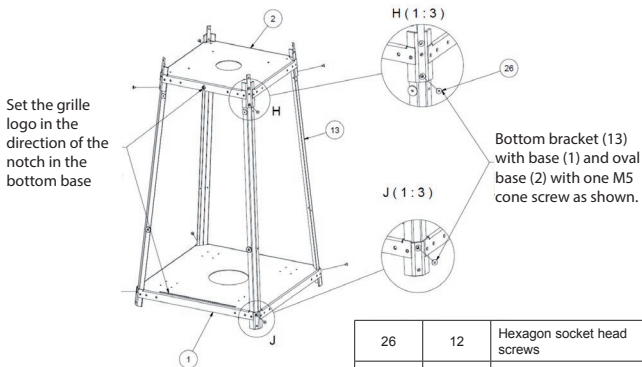

26	12	Hexagon socket head screws
13	4	Bottom angle
2	1	Palmica base, set
1	1	Base
Position	Number	Name

Step 2. Screw the angles (5) with the existing body and a cap (6) as per drawing below.

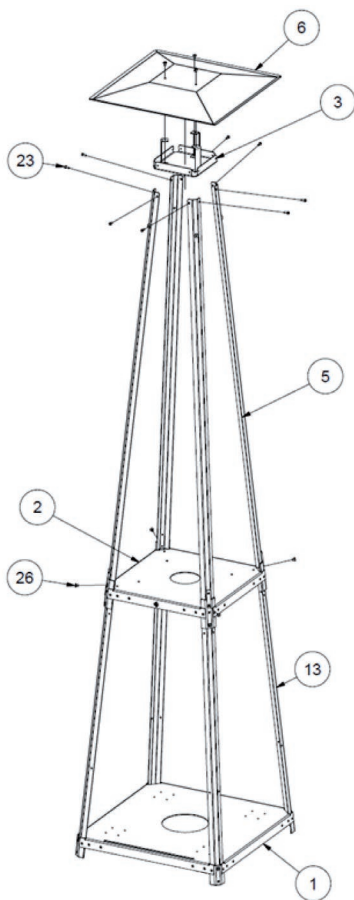

26	12	hexagon head screw
23	8	socket head cap screws with hexagon socket
13	4	bottom angle
6	1	radiator
5	4	upper angle
3	1	top shelf
2	1	burner base
1	1	basis

Step 3. Screw the box with the burner and control valve (7) and then place a burner cover (10) as per drawing below.

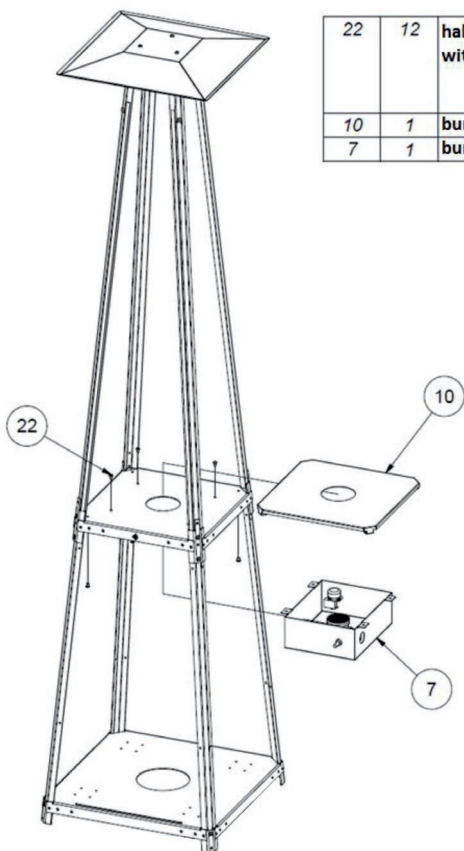

22	12	half round head screw with hexagon socket
10	1	burner cover
7	1	burner and valve box

Step 4. Screw the magnets (16) with the magnet washer (9) to the bottom angles (13) from the notch in the base side as per drawing below.

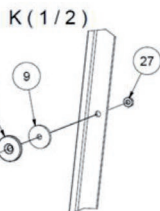
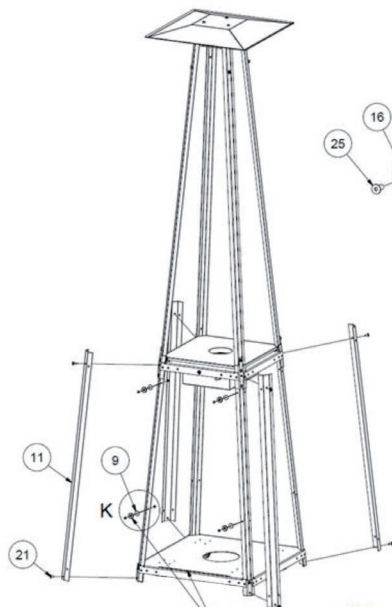

27	4	low hexagon nuts
25	4	hexagon socket head cap screws
21	24	half round head screws with hexagon socket
16	4	20x3 M4 magnet
13	4	bottom angle
11	4	bottom masking strip
9	4	magnet washer

screw the magnets (16) and washer (9) to the lower angle brackets (13) from the side cutout in the base

Step 5.

Cover the side edges of the glass (14) with a string (15) on both sides, slide the glass under the bottom masking strips (11) and tighten the top masking strips (8)

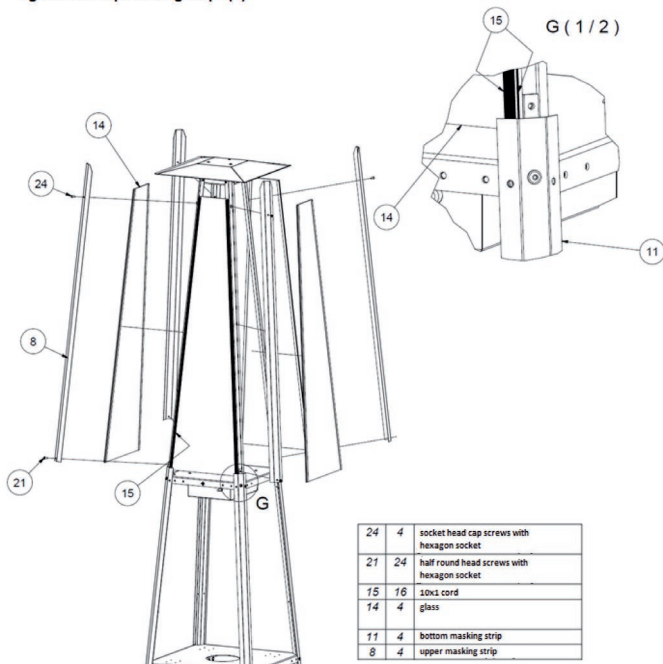

Step 6. Screw the side covers (12) and put the door (4) in by sliding them into the cutout in the base of the appliance.

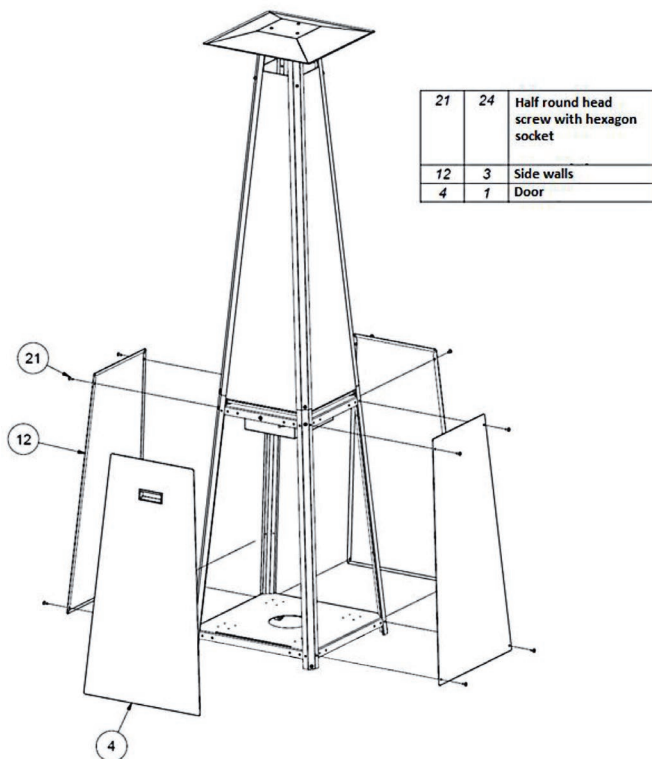
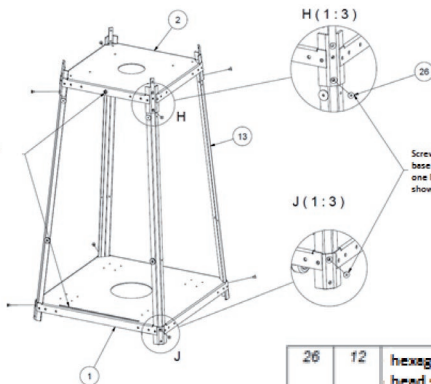

Fig. 3. Installation diagram of the SIENA gas outdoor heater

SIENA/BS VERSION

Step 1. The Base of the burner (2) shall be installed with the logo of The Flame in the same direction as the hole in the base of the body (1). Then screw in the angles (13) with both burner base and body base as per the drawing below.

Set the base of the burner with logo in the same direction as the hole in the base



Screw the bottom angle (13) with the base (1) and the burner base (2) with one M5 countersunk screw as shown.

26	12	hexagon head screw
13	4	bottom angle
2	1	burner base
1	1	base

Step 2. Screw the glasses (8.2) and the radiator (8.12) to the burner base using the mounts and screws as per diagram below.

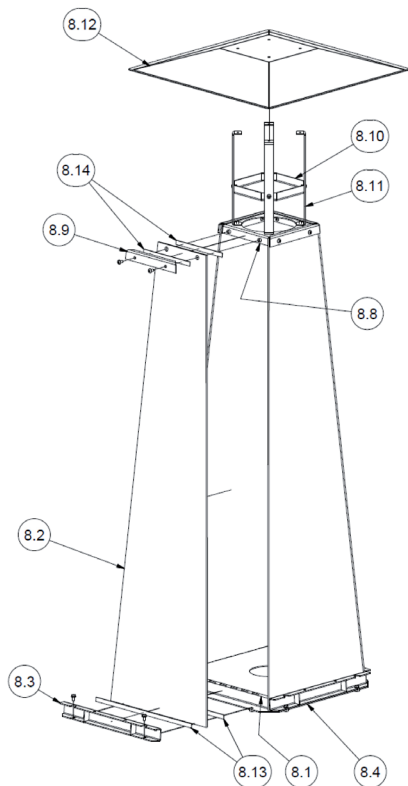

8.14	8	Rope
8.13	8	Rope
8.12	1	Radiator
8.11	4	Attaching the roof
8.10	1	top mount
8.9	4	Glass strip
8.8	1	Upper window fixing
8.7	8	Steel washer
8.6	8	Hexagon head screw
8.5	8	Half round head screw with hexagon socket
8.4	1	Welded glass base
8.3	4	Windshield support
8.2	4	Glass
8.1	1	Burner cover

Fig. 4. Installation diagram of the SIENA/BS gas outdoor heater

Step 3 i 4. Screw the burner as per diagrams on page 13 and 16.

While installing the SIENA/BS version you must put the high temperature silicone sealings provided by the manufacturer and cut to size, on each glass left side at full length of the glass, to seal the combustion chamber if the glass chamber would not be preinstalled.

CHOOSING THE LOCATION OF THE GAS OUTDOOR HEATER

The SIENA gas garden heater is a mobile device capable of movement to any place of your choice. However, there are restrictions that must be strictly followed. The device, due to the possibility of high temperatures on its external surfaces, should be kept away from flammable materials, and also due to the open combustion chamber without the possibility of connecting to chimney flues, it should be used in open spaces or in well-ventilated rooms. IT IS ABSOLUTELY PROHIBITED to place the device in a position other than vertical.

Tips for proper and safe installation of the device:

- Connect the regulator to a cylinder or a household liquid gas installation, so that the valve does not affect the horizontal position of the burner together with its other components. Connecting it in any other way may block the gas supply to the device. To do this, use the appropriate tools. Tightening the regulator by hand is insufficient and may result in gas leakage. Cylinder replacement and / or connection should take place in well ventilated areas.
- Make sure that the rubber gaskets are in place and undamaged before connecting the gear unit. If this is not the case, the device cannot be used until the seal has been replaced.
- Remember that the gas cylinder should always be in an upright position and the hose connecting the cylinder to the burner should be laid in such a way that it does not come into contact with sharp objects or edges, as well as hot elements of the burner.
- Check the correctness and tightness of the installed gas control system and the entire gas system of the device. To do this, you can use soapy water or a dedicated spray to detect gas leaks. To check for leaks, cover with water and soap or spray any connections (cylinder- reducer, reducer - gas hose, gas hose - controller gas block, gas block - copper wires for the magnetos and main burner, main burner nozzle - copper wire) between the cylinder and the controller and those behind the gas block, and then ignite the device so that the gas also fills the section from the gas block to the burner nozzles. If bubbles appear on the joints, it means that there is a leak in this place.

ATTENTION: Safe distances from flammable materials that should be observed in accordance with the instructions in this manual have been established on the basis of safety tests. Flammable materials can be called anything that can catch fire, i.e. paper, wood, all kinds of fuels, plastic, clothing, etc. The designated space is not limited by non-flammable materials, but also applies to flammable materials directly behind non-flammable objects exposed to contact with device.

If you are unsure of the flammability of any material within the device, consult your fire brigade.

Remember that fireproof materials are considered flammable despite their fire resistance. They can be difficult to set on fire, but they also burn.

MOVING OF THE APPLIANCE

This appliance has been designed for easy movement. However, safety precautions should be taken and moving the device in accordance with the instructions below:

- Shut off the appliance and close the gas valve on the gas supply!
- If the gas cylinder is inside the appliance, take it off before moving the appliance!
- Ask someone to help you. Moving the device should be done with two people!

Move the appliance using the handles on both sides of the appliance. When the appliance would be placed on its destination, make sure that it is stable before connect to the gas cylinder!

The SIENA gas garden heater has been tested and approved for heating open or well ventilated spaces, subject to safe distances from flammable materials, as shown in the diagrams below.

The instructions for safe device installation included in this manual must be strictly observed. It is the user's responsibility to ensure that the device is in an area free of flammable materials as per the diagram below

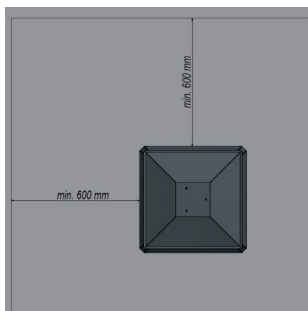

Fig. 5. Diagram of a safe space free of flammable materials.

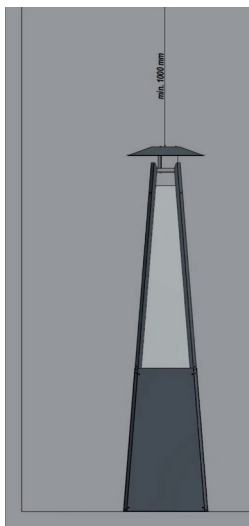

Fig. 6. Diagram of the minimum safe distance above the heater from combustible materials.

The space indicated above is the minimum free space from flammable materials, unless this is removed by another entry. Failure to observe the above clearances (free space) may result in a fire.

ATTENTION!!!

It is absolutely prohibited to use a gas garden heater in an open space during ATMOSPHERIC precipitation.

STORING A GAS GARDEN HEATER OUTSIDE THE BUILDING IS ONLY PERMITTED WHEN COVERING THE RAIN COVER.

IN ANY OTHER ACCIDENT, THE DEVICE SHOULD BE LOCATED IN A PLACE WHICH PROTECTED AGAINST FLOODING AND EFFECTS OF LOW TEMPERATURES.

THE GAS SUPPLY SHALL BE CUT OFF WHEN THE APPLIANCE IS NOT IN OPERATION. (GAS VALVE IN THE CLOSED POSITION OR GAS SUPPLY DISCONNECTED), ALL SAFETY HANDLES SHOULD BE LOCKED, AND THE DEVICE PROTECTED AGAINST FALLING. IF IT IS NOT POSSIBLE TO PROTECT THE APPLIANCE AGAINST IT OVERTURNING OR FALLING OUT LEAVING IT WITHOUT ATTENTION, THE GAS BOTTLE SHOULD BE DISCONNECTED AND LEAVED IN A SAFE PLACE.

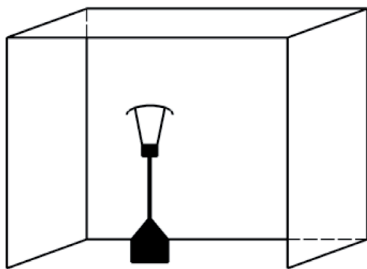

THE USE OF THIS APPLIANCE IN ENCLOSED AREAS IS DANGEROUS AND IT IS PROHIBITED!

- FOR USE OUTDOORS OR IN AMPLY VENTILATED ARE
- AN AMPLY VENTILATED AREA MUST HAVE A MINIMUM OF 25% OF THE SURFACE AREA OPEN
- THE SURFACE AREA IS THE SUM OF THE WALLS SURFACE

FIRST START

Before first use, make sure that all connections of individual system components have been made in accordance with the instructions contained in the manual. Incorrect connection of the gas control system may result in its damage.

During the first few ignitions a specific smell may be perceptible, persisting even for several hours after using the device. This phenomenon is associated with the burning of paint. Animals may be particularly sensitive to smells caused by burning off paint. To speed up the process, it is recommended to heat the device to maximum flame for several hours.

INSTALLATION OF GAS CONTROL SYSTEM

ATTENTION!!!

This appliance together with the gas control system can only be installed at the factory settings.

ATTENTION!!!

Individual elements of the gas control system should be installed in accordance with the instructions in this manual.

The standard gas control system includes a manual control valve. Elements of the system should be installed in places designated for this. Moving them may expose the device to damage due to harmful temperatures or flooding.

The appliance can only work with the gas control valve supplied with the appliance. Connections of individual system components have been made in such a way as to prevent their improper connection.

WARNING! The device is equipped with a very sensitive anti-tilt valve. Shaking of the ground or the device itself as a result of impact or other forces may cause cutting off the gas supply to the device, and thus shutting it down. If you notice that the device does not burn, immediately turn the knob to the closed position clockwise and according to the instructions in the section „lighting the device“.

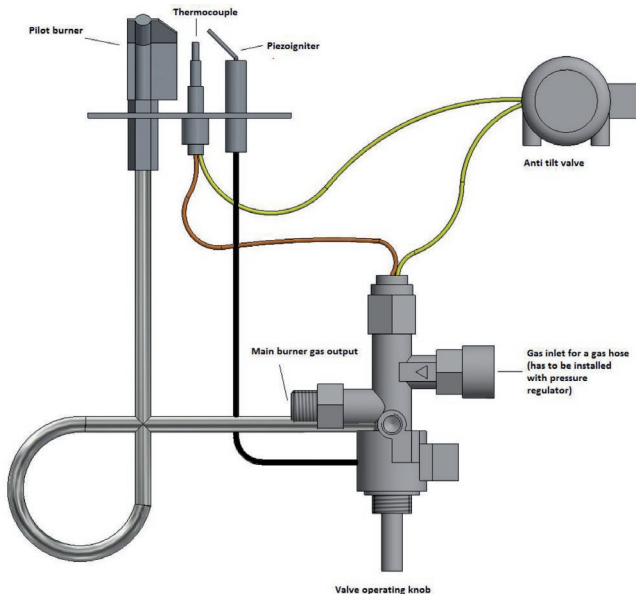

Fig. 7. Connection diagram for the manual gas control system

CONNECTION TO THE GAS SOURCE (GAS BOTTLES/CYLINDERS)

ATTENTION: To connect the appliance to the gas cylinder customer has to buy and connect at least 60 cm CE and GAR approved flexible hose with forged connectors, flexible hose with steel mesh braid or flexible steel hose.

The gas supply connection is placed in side the chamber and it is standard R 1/2" screw connection with external thread for standard hose connection.

The choose of the regulator shall be made in accordance with the specification note in the table on page 7 or on a rating label.

ATTENTION: Picking up the wrong pressure while choosing the regulator may lead to incorrect combustion, smoking or even may cause health problems. Never connect the wrong pressure regulator for connection of the appliance to the gas supply than the one stated in table on page 7 or on your appliance's rating label.

All connections shall be made by a qualified serviceman and only on a not working, disconnected from the gas supply, appliance.

Connect the regulator to the cylinder making sure that the seals are in place (See diagram above), if the seals are old or damaged or if one of them is missing, the device cannot be used until the seals are replaced. The valve must remain in the position it is installed at the factory. Changing the angle of the valve with anti-tilt valve results in closing the gas supply to the device and thus switching it off.

ATTENTION!!!

The anti-tilt valve is a protection against overturning of the appliance, thanks to which in the event of the appliance overturning, the valve automatically cuts off the gas supply to the controller, which extinguishes the flame.

ATTENTION!

The appliance should be connected to the gas source only when the heater is turned off and the cylinder valve is turned off.

Never connect the gas cylinder directly to the appliance without the regulator!

ATTENTION!

It is forbidden to use open fire during the installation process or connecting the cylinder. Failure to comply with this prohibition may result in fire, explosion, property damage, personal injury, and even loss of life.

ATTENTION!

Gas garden fireplaces are designed to work with a propane and propane-butane cylinder in size of 5 and 11 kgs (the sizes may vary depending to the country you are buying them in). The device is sold with complete automation with anti-tilting valve.

Before replacing the cylinder, make sure that the device is not near to any sources of fire or other sources that could ignite.

It is essential to close the gas supply valve on the cylinder or regulator after each use.

If you feel any gas leakage, you must absolutely stop using the device, if it is running or if it is turned off, do not start it. Then contact the service center.

ATTENTION:

It is recommended to periodically check the quality of connections for all gas hoses including the rubber flexible hose (at least once a month or whenever the cylinder is replaced). If there are visible cracks, damage or other signs of damage, the elements should be replaced with new ones of the same length and equivalent quality.

ATTENTION:

Please note that the gas cylinder while installed inside the appliance has to be fastened with a cord with a carabiners to the bottom brackets as per drawing below:

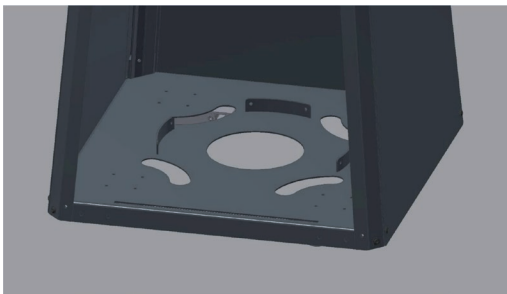

Fig. 8. An overview of the of the bottom brackets.

OPERATION

The user choosing the gas outdoor heater receives a device equipped with a manual controller. Before operating the control module, read this manual. Proceedings contrary to the instructions or contrary to the instructions may result in damage to the gas control system components or the device itself, as well as to fire, property damage or loss of health.

INSTRUCTIONS FOR MANUAL CONTROL MODULE

Firing up the appliance should follow the instructions below. The manual control system has been designed to completely eliminate the need for its maintenance and any adjustment. Never attempt to open or damage the valve or any of its other components in any way.

Firing up the appliance:

1. If you have just connected a gas cylinder to your device, bleed the control lines. Pressing the knob, turn them counterclockwise until it stops and hold them for a maximum of 5 seconds (the gas will flow to the pilot burner, but also to the main burner).
2. Continue pressing the knob and turn it back to the starting position and counterclockwise again until it locks (this activates the pilot burner piezo igniter). Repeat as long as the pilot burner lights up. (If this operation lasts longer than 30 seconds, wait 5 minutes and try again. If re-lighting does not cause the pilot burner to fire, contact the service).
3. After the pilot burner has ignited, keep the knob pressed in this position for another 10 seconds until the pilot burner has ignited.
4. After ignition of the pilot burner, hold the knob in this position for 5 seconds until the thermocouple warms up, then release the knob and turn it counterclockwise further. You will feel the resistance when reach the final position – this is the maximum power input and height of the flame available (this will also start gas flow to the main burner) . Do not try to push it even further!

5. The adjustment is done by turning the knob from the final position (maximum power) to the firing up position of the pilot burner (minimum power).

Turning off the appliance:

1. Turn the knob to the control torch firing position clockwise.
2. Press the knob lightly and continue turning it clockwise from the end position completely closing the valve.

The next procedure of firing up the pilot burner may be repeated when the thermocouple of the pilot burner has sufficiently cooled (the period until it cools down may vary depending on the type of thermocouple used). After the device is completely turned off, re-lighting is possible after about 1 minute (time needed for the thermocouple to cool down).

Ignition

The knob is in the closed position. They must be pressed in and turned counterclockwise. The thermo-electric valve after pressing the knob is open (pos. 1), gas is supplied to the pilot burner. (pos. 2.). The procedure should be repeated until the pilot burner lights up.

WARNING! When firing the device, gas also flows to the main burner. Be absolutely careful of everything in the vicinity of the burner, taking into account the risk of gas accumulation due to repeated firing attempts, which may result in violent ignition. It is strictly forbidden to place any objects or to look at the burner up close when trying to fire the device.

ATTENTION!

ALL PICTURES OF THE KNOB SHOWS ITS NORMAL POSITION WHEN STANDING IN FRONT OF INSTALLED APPLIANCE!

Pos. 1.



Pos. 2.**Low flame**

The knob is in the firing position of the pilot burner (pos. 2). Gas flows to the main burner at minimum power settings.

High flame

The knob is in the firing position of the pilot burner (pos. 2). To increase the power to the maximum power level, and thus also the flame height, or to any intermediate power between the minimum and maximum power, turn the knob counterclockwise until it locks. The knob is in the maximum power position. (pos. 3.).

**MAINTENANCE****ATTENTION!!!**

All maintenance work should be carried out on the refrigerated appliance with the gas supply cut off and the power supply disconnected.

ATTENTION!!!

Gas garden fireplace maintenance may only be performed by a qualified technician.

- The appliance should be periodically inspected at least once a month or whenever the cylinder is changed.
- Cleaning should take place regularly or as dust or dirt appears on the appliance.
- It is forbidden to make any changes to the device's design.
- The gas garden fireplace should not be cleaned with caustic agents.
- When replacing individual parts, use only original parts available from the manufacturer

Checklist:

L.p	Scope	Actions
1	General control	<p>Perform firing up procedure of your gas garden fireplace.</p> <p>Check the operation of all security systems.</p> <p>Check if the main burner flame burns steadily.</p> <p>Check that the main burner burns evenly.</p>
2	Control of gas control system	<p>Check the gas connections for leaks.</p> <p>Check that the cylinder chamber ventilation is not blocked.</p> <p>Check that the gas control system components are not exposed to high temperatures.</p> <p>Check that the inner chamber and the elements installed in it are not exposed to moisture. Check that the connecting cables show no signs of corrosion.</p>
3	Combustion chamber control	<p>Check that the pilot burner is not obstructed by decorative elements.</p> <p>Check if the thermocouple is within the pilot burner flame.</p> <p>Check whether the combustion chamber requires cleaning.</p> <p>Check the glasses if there are any visible dirt of sooting process.</p> <p>Check that all air inlets to the combustion chamber are clear. If necessary, clear the holes.</p> <p>Check the combustion chamber for signs of corrosion. If necessary, remove corrosion and cover the defects with a new layer of fireplace paint.</p> <p>Check if the main burner ignites smoothly.</p>
4	Control device control	<p>Check for a puncture in the circuits.</p> <p>Check that the components of the control system are not exposed to overheating.</p>
5	Decorative elements	<p>Check if the decorative elements require cleaning.</p> <p>Check that the decorative elements are not in contact with the glass.</p> <p>Check if the decorative elements cover the openings venting the hearth.</p> <p>Check that the decorative elements have not been damaged.</p>

ENVIRONMENTAL PROTECTION

- All packaging components in which the gas garden fireplace has been supplied should be disposed of in a manner appropriate to their type.
- If the device is used up again, it must be disposed of. The user is obliged to pass the fireplace to the appropriate institution dealing in the recycling of this type of equipment.